

isiprex

2024



Made in Italy

CATALOGO PRODOTTI – PRODUCT CATALOG

Stainless Steel · Tubes · Fittings



INDICE

- **SPECIFICHE**

Pag. 3 – 5

- **TUBI**

Pag. 9 – 13

Contattare per:

– Extra Diametri 139,7 – 168,3 mm

- **RACCORDERIE**

PROFILO “M” Pag. 14 – 33

PROFILO “V” Pag. 34 – 47

Contattare per:

– informazioni su Raccorderie Gas

– Extra Diametri 139,7 – 168,3mm

- **ACCESSORI**

Pag. 48 – 51



INDEX

- **SPECIFICATIONS**

Page 6 – 8

- **CONDUIT PIPES**

Page 9 – 13

Please contact us for:

– Extra Diameters 139,7 – 168,3mm

- **PRESS FITTINGS ***

“M” PROFILE Page 14 – 33

“V” PROFILE Page 34 – 47

Please contact us for:

– infos regarding Gas Press Fittings

– Extra Diameters 139,7 – 168,3mm

- **ACCESSORIES**

Page 48 – 51

Isiprex S.r.l.s.

+39 339 28 23 799

Via Cercè 10, 23842
Bosisio Parini (LC)

info@isiprex.com
P.IVA 03820370132

SPECIFICHE



Tubi di condotta

I tubi di condotta forniti da Isiprex sono realizzati in acciaio inossidabile austenitico e ferritico secondo le norme UNI EN 10088-2, UNI EN 10217-7 e UNI EN 10312.

I tubi forniti da Isiprex sono conformi alle omologazioni ottenute e in particolare alle specifiche tecniche DWGW W 541 e VdS, seguiti dai numeri di omologazione e possono essere utilizzati per tutte le applicazioni.

Diametro esterno per spessore d x s (mm)	DN	Volume di acqua contenuta (dm ³ /m)	Peso a vuoto (Kg/m)
15,0 x 1,0	12	0,133	0,351
18,0 x 1,0	15	0,201	0,426
22,0 x 1,2	20	0,302	0,625
28,0 x 1,2	25	0,514	0,805
35,0 x 1,5	32	0,804	1,258
42,0 x 1,5	40	1,195	1,521
54,0 x 1,5	50	3,043	1,972
76,1 x 2,0	65	4,083	3,711
88,9 x 2,0	80	5,661	4,352
108,0 x 2,0	100	8,495	5,308

Raccordi a pressare (316L EN 1.4404)

Per l'applicazione acqua potabile, i raccordi a pressare forniti da Isiprex sono certificati da numerosi Enti internazionali. In particolare sono stati largamente superati gli elevati standard qualitativi richiesti dalla specifica tecnica tedesca DWGW W 534.

NOTA: Gli o-ring in HNBR e FPM non utilizzabili in quanto non omologati per la conduzione di acqua potabile.

O-Ring

L'anello di tenuta è realizzato in EPDM di colore nero ed è resistente all'invecchiamento, al calore e agli additivi chimici, risultando particolarmente indicato per tutti i tipi di acqua trattata.

E' disponibile nelle versioni "standard" e "gocciolante". Esso inoltre soddisfa tutti i requisiti di igienicità, in conformità alla specifica tecnica DWGW W 270 e al Decreto Ministeriale 174/2004.

Condizioni di impiego:

- Pressione max: 16 bar
- Depressione relativa max: - 0,8 bar (pressione assoluta: 0,2 bar)
- Temperatura max: 120°C

Applicazione per antincendio e sprinkler

Il sistema di Pressfitting in acciaio inossidabile fornito da Isiprex viene utilizzato anche per impianti antincendio fissi a umido e a secco, per i diametri da 22 a 108 mm.

Esso è conforme alla norma UNI EN 12845, riguardante i sistemi automatici a sprinkler e alla norma UNI 10779 (ed analoghe nazionali), per quanto concerne l'alimentazione di idranti e naspi.

Condizioni di impiego per naspi e idranti

- Pressione max: 16 bar

Condizione di impiego per sprinkler

- Pressione max per i diametri fino a 76,1 mm: 16 bar
- Pressione max per i diametri 88,9 e 108 mm: 12,5 bar

La Certificazione per antincendio a sprinkler secondo la linea guida tedesca VdS – CEA 4001



Attrezzature di pressatura

La pressatura avviene per mezzo di pressatrici, attrezzate con terminali avvolgenti intercambiabili (ganasse o catene), che variano in funzione dei diametri:

- Portatili a bassa forza (fino a 17KN)
- A media forza (fino a 40 KN)
- A forza elevata (oltre i 40KN)

I sistemi forniti da Isiprex prevedono l'utilizzo di pressatrici di vario tipo che devono però essere attrezzate solo ed esclusivamente con terminali a profilo "M".

Isiprex è in grado di fornire pressatrici provenienti dalla casa Novopress, una delle migliori marche sul mercato.

O-RING: Caratteristiche e applicazioni

Materiale	Norma di riferimento	Temperature min e max	Pressione max	Applicazioni
EPDM nero	EN 681	-20 / +120°C	16 bar	- Acqua potabile - Riscaldamento e raffreddamento - Antincendio - Vapore - Aria compressa (disoleata) - Gas inerti
HNBR giallo	EN 681	-20 / +70°C	5 bar	- Gas naturali - Metano - Gas liquidi
FPM verde	EN 681	-20 / +180°C	16 bar	- Solare - Olii - Carburanti
FPM rosso	EN 681	-20 / +180°C	16 bar	- Applicazioni industriali - Aria compressa (con olio)

Raccomandazioni:

- Per Riscaldamento e Raffreddamento utilizzare l'antigelo in percentuale massima del 50%
- Bagnare l'o-ring con acqua prima di inserire il tubo nel raccordo



Materiali tubi da condotta

AUSTENITICO AMAGNETICO

EN	ASTM						
1.4404	316L						
C	Si	Mn	P	S	Cr	Ni	Mo
≤0.030	≤0.75	≤2.00	≤0.040	≤0.030	16.00-18.00	10.00-12.00	2.00-2.50
Rp _{0.2}		Rm		Elongation		Hardness	
>240 N/mm ²		540 - 620 N/mm ²		> 45%		< 200HB	

EN	ASTM						
1.4301	304						
C	Si	Mn	P	S	Cr	Ni	
≤0.030	≤0.75	≤2.00	≤0.040	≤0.015	17.50-18.00	8.00-10.00	
Rp _{0.2}		Rm		Elongation		Hardness	
>230 N/mm ²		540 - 670 N/mm ²		> 45%		< 200HB	

FERRITICO MAGNETICO

EN	ASTM							
1.4521	444							
C	Si	Mn	P	S	Cr	Mo	Ti	Nb
≤0.025	≤1.00	≤1.00	≤0.040	≤0.015	17.50-18.50	1.80-2.00	0.12-0.40	0.25-0.50
Rp _{0.2}		Rm		Elongation		Hardness		
>320 N/mm ²		420 - 640 N/mm ²		min 28%		max 217HB		

* I tubi con AISI 1.4404 (316L) e AISI 1.4521 (444) possiedono certificazione DVGW.

SPECIFICATIONS

Conduit pipes

The conduit pipes supplied by Isiprex are made of austenitic and ferritic stainless steel according to UNI EN 10088-2, UNI EN 10217-7 and UNI EN 10312 standards.

The pipes supplied by Isiprex comply with the approvals obtained and in particular with the technical specifications DWGW W 541 and VdS, followed by the approval numbers and can be used for all applications.

External diameter for thickness d x s (mm)	DN	Volume of water contained (dm ³ /m)	Empty weight (Kg/m)
15,0 x 1,0	12	0,133	0,351
18,0 x 1,0	15	0,201	0,426
22,0 x 1,2	20	0,302	0,625
28,0 x 1,2	25	0,514	0,805
35,0 x 1,5	32	0,804	1,258
42,0 x 1,5	40	1,195	1,521
54,0 x 1,5	50	3,043	1,972
76,1 x 2,0	65	4,083	3,711
88,9 x 2,0	80	5,661	4,352
108,0 x 2,0	100	8,495	5,308

Press fittings (316L EN 1.4404)

For the application of drinking water, the press fittings supplied by Isiprex are certified by numerous international bodies. In particular, the high quality standards required by the German technical specification DVGW W 534 have been greatly exceeded.

NOTE: The HNBR and FPM O-rings cannot be used as they are not approved for the conduction of drinking water.

O-Ring

The sealing ring is made of black EPDM and is resistant to aging, heat and chemical additives, making it particularly suitable for all types of treated water.

It is available in "standard" and "dripping" versions. It also meets all hygiene requirements, in compliance with the DVGW W 270 technical specification and Ministerial Decree 174/2004.

Employment conditions:

- Max pressure: 16 bar
- Max. Relative depression: - 0,8 bar (absolute pressure: 0,2 bar)
- Max temperature: 120°C

Application for firefighting and sprinklers

The stainless steel pressfitting system supplied by Isiprex is also used for wet and dry fixed firefighting systems, for diameters from 22 to 108 mm.

It complies with UNI EN 12845, concerning automatic sprinkler systems and UNI 10779 (and similar national standards), as regards the feeding of hydrants and reels.

Conditions of use for hose reels and hydrants

- Max pressure: 16 bar

Condition of use for sprinklers

- Max pressure for diameters up to 76,1 mm: 16 bar
- Max pressure for diameters 88,9 e 108 mm: 12,5 bar

Certification for sprinkler fire protection according to the German guideline VdS - CEA 4001

Pressing equipment

The pressing takes place by means of pressing machines, equipped with interchangeable wrapping terminals (jaws or chains), which vary according to the diameters:

- Portable at Low strength (until 17KN)
- At medium strength (until 40 KN)
- At elevate strength (more than 40KN)



The systems supplied by Isiprex provide for the use of various types of pressers which must, however, be equipped only and exclusively with "M" profile terminals.

Isiprex is able to supply pressing tools from Novopress, one of the best brands on the market.

O-RING: Features and applications

Material	Reference standard	Temperature min and max	Max pressure	Applications
EPDM black	EN 681	-20 / +120°C	16 bar	- Drinkable water - Heating and cooling - Firefighting - Steam - compressed air (de-oiled) - Inert gas
HNBR yellow	EN 681	-20 / +70°C	5 bar	- Natural gas - Methan - Liquid gas
FPM green	EN 681	-20 / +180°C	16 bar	- Solar systems - Oils - Fuels
FPM red	EN 681	-20 / +180°C	16 bar	- Industrial applications - Compressed air (with oil)

Recommendations:

- For Heating and Cooling use the antifreeze in a maximum percentage of 50%
- Wet the o-ring with water before inserting the tube into the fitting

Conduit pipes material

AUSTENITIC NON-MAGNETIC

EN	ASTM						
1.4404	316L						
C	Si	Mn	P	S	Cr	Ni	Mo
≤0.030	≤0.75	≤2.00	≤0.040	≤0.030	16.00-18.00	10.00-12.00	2.00-2.50
Rp _{0.2}		Rm		Elongation		Hardness	
>240 N/mm ²		540 - 620 N/mm ²		> 45%		< 200HB	

EN	ASTM						
1.4301	304						
C	Si	Mn	P	S	Cr	Ni	
≤0.030	≤0.75	≤2.00	≤0.040	≤0.015	17.50-18.00	8.00-10.00	
Rp _{0.2}		Rm		Elongation		Hardness	
>230 N/mm ²		540 - 670 N/mm ²		> 45%		< 200HB	

MAGNETIC FERRITIC

EN	ASTM							
1.4521	444							
C	Si	Mn	P	S	Cr	Mo	Ti	Nb
≤0.025	≤1.00	≤1.00	≤0.040	≤0.015	17.50-18.50	1.80-2.00	0.12-0.40	0.25-0.50
Rp _{0.2}		Rm		Elongation		Hardness		
>320 N/mm ²		420 - 640 N/mm ²		min 28%		max 217HB		

* Pipes with AISI 1.4404 (316L) and AISI 1.4521 (444) have DVGW certification.

TUBI 

CONDUIT PIPES 



Contattare per quotazione

TUBO 316L - DVGW		AISI	d	s	L(m)	€	vapore saturo	aria compressa	anti incendio	nebulizzazione
EN 1,4404		1,4404	12	1	6		SI	SI	-	-
		1,4404	15	1	6		SI	SI	-	SI
		1,4404	18	1	6		SI	SI	SI	-
		1,4404	22	1,2	6		SI	SI	SI	-
		1,4404	28	1,2	6		SI	SI	SI	-
		1,4404	35	1,5	6		SI	SI	SI	-
		1,4404	42	1,5	6		SI	SI	SI	-
		1,4404	54	1,5	6		SI	SI	SI	-
		1,4404	76,1	2	6		SI	SI	SI	-
		1,4404	88,9	2	6		SI	SI	SI	-
Crudo / Ricotto		1,4404	108	2	6		SI	SI	SI	-

TUBO 316 - DVGW		AISI	d	s	L(m)	€	vapore saturo	aria compressa	anti incendio	nebulizzazione
EN 1,4401		1,4401	12	1	6		SI	SI	-	-
		1,4401	15	1	6		SI	SI	-	SI
		1,4401	18	1	6		SI	SI	SI	-
		1,4401	22	1,2	6		SI	SI	SI	-
		1,4401	28	1,2	6		SI	SI	SI	-
		1,4401	35	1,5	6		SI	SI	SI	-
		1,4401	42	1,5	6		SI	SI	SI	-
		1,4401	54	1,5	6		SI	SI	SI	-
		1,4401	76,1	2	6		SI	SI	SI	-
		1,4401	88,9	2	6		SI	SI	SI	-
Crudo / Ricotto		1,4401	108	2	6		SI	SI	SI	-

TUBO 444 - DVGW		AISI	d	s	L(m)	€	vapore saturo	aria compressa	anti incendio	nebulizzazione
EN 1,4521		1,4521	15	1	6		NO	SI	-	NO
		1,4521	18	1	6		NO	SI	-	NO
		1,4521	22	1,2	6		NO	SI	SI	NO
		1,4521	28	1,2	6		NO	SI	SI	NO
		1,4521	35	1,5	6		NO	SI	SI	NO
		1,4521	42	1,5	6		NO	SI	SI	NO
		1,4521	54	1,5	6		NO	SI	SI	NO
		1,4521	76,1	2	6		NO	SI	SI	NO
		1,4521	88,9	2	6		NO	SI	SI	NO
	Crudo / Ricotto		1,4521	108	2	6		NO	SI	SI

Contattare per quotazione

TUBO 304L - ISO	AISI	d	s	L(m)	€	vapore saturo	aria compressa	anti incendio	nebulizzazione
EN 1,4307	1,4307	15	1	6		NO	SI	—	NO
	1,4307	18	1	6		NO	SI	—	NO
	1,4307	22	1,2	6		NO	SI	SI	NO
	1,4307	28	1,2	6		NO	SI	SI	NO
	1,4307	35	1,5	6		NO	SI	SI	NO
	1,4307	42	1,5	6		NO	SI	SI	NO
	1,4307	54	1,5	6		NO	SI	SI	NO
	1,4307	76,1	2	6		NO	SI	SI	NO
Crudo / Ricotto	1,4307	88,9	2	6		NO	SI	SI	NO
	1,4307	108	2	6		NO	SI	SI	NO

TUBO 304 - ISO	AISI	d	s	L(m)	€	vapore saturo	aria compressa	anti incendio	nebulizzazione
EN 1,4301	1,4301	15	1	6		NO	SI	—	NO
	1,4301	18	1	6		NO	SI	—	NO
	1,4301	22	1,2	6		NO	SI	SI	NO
	1,4301	28	1,2	6		NO	SI	SI	NO
	1,4301	35	1,5	6		NO	SI	SI	NO
	1,4301	42	1,5	6		NO	SI	SI	NO
	1,4301	54	1,5	6		NO	SI	SI	NO
	1,4301	76,1	2	6		NO	SI	SI	NO
Crudo / Ricotto	1,4301	88,9	2	6		NO	SI	SI	NO
	1,4301	108	2	6		NO	SI	SI	NO

Please contact us for a quote

PIPE 316L - DVGW		AISI	d	s	L(m)	€	steam	compressed air	fire systems	nebulization
EN 1,4404	1,4404	12	1	6			YES	YES	YES	-
	1,4404	15	1	6			YES	YES	YES	YES
	1,4404	18	1	6			YES	YES	YES	-
	1,4404	22	1,2	6			YES	YES	YES	-
	1,4404	28	1,2	6			YES	YES	YES	-
	1,4404	35	1,5	6			YES	YES	YES	-
	1,4404	42	1,5	6			YES	YES	YES	-
	1,4404	54	1,5	6			YES	YES	YES	-
	1,4404	76,1	2	6			YES	YES	YES	-
	1,4404	88,9	2	6			YES	YES	YES	-
Raw / Annealed	1,4404	108	2	6			YES	YES	YES	-

PIPE 316 - DVGW		AISI	d	s	L(m)	€	steam	compressed air	fire systems	nebulization
EN 1,4401	1,4401	12	1	6			YES	YES	-	-
	1,4401	15	1	6			YES	YES	-	YES
	1,4401	18	1	6			YES	YES	YES	-
	1,4401	22	1,2	6			YES	YES	YES	-
	1,4401	28	1,2	6			YES	YES	YES	-
	1,4401	35	1,5	6			YES	YES	YES	-
	1,4401	42	1,5	6			YES	YES	YES	-
	1,4401	54	1,5	6			YES	YES	YES	-
	1,4401	76,1	2	6			YES	YES	YES	-
	1,4401	88,9	2	6			YES	YES	YES	-
Raw / Annealed	1,4401	108	2	6			YES	YES	YES	-

PIPE 444 - DVGW		AISI	d	s	L(m)	€	steam	compressed air	fire systems	nebulization
EN 1,4521	1,4521	15	1	6			NO	YES	-	NO
	1,4521	18	1	6			NO	YES	-	NO
	1,4521	22	1,2	6			NO	YES	YES	NO
	1,4521	28	1,2	6			NO	YES	YES	NO
	1,4521	35	1,5	6			NO	YES	YES	NO
	1,4521	42	1,5	6			NO	YES	YES	NO
	1,4521	54	1,5	6			NO	YES	YES	NO
	1,4521	76,1	2	6			NO	YES	YES	NO
	1,4521	88,9	2	6			NO	YES	YES	NO
	Raw / Annealed	1,4521	108	2	6			NO	YES	YES

Please contact us for a quote

PIPE 304L - ISO		AISI	d	s	L(m)	€	steam	compressed air	fire systems	nebulization
EN 1,4307		1,4307	15	1	6		NO	YES	—	NO
		1,4307	18	1	6		NO	YES	—	NO
		1,4307	22	1,2	6		NO	YES	YES	NO
		1,4307	28	1,2	6		NO	YES	YES	NO
		1,4307	35	1,5	6		NO	YES	YES	NO
		1,4307	42	1,5	6		NO	YES	YES	NO
		1,4307	54	1,5	6		NO	YES	YES	NO
		1,4307	76,1	2	6		NO	YES	YES	NO
Raw / Annealed		1,4307	88,9	2	6		NO	YES	YES	NO
		1,4307	108	2	6		NO	YES	YES	NO

PIPE 304 - ISO		AISI	d	s	L(m)	€	steam	compressed air	fire systems	nebulization
EN 1,4301		1,4301	15	1	6		NO	YES	NO	NO
		1,4301	18	1	6		NO	YES	NO	NO
		1,4301	22	1,2	6		NO	YES	NO	NO
		1,4301	28	1,2	6		NO	YES	NO	NO
		1,4301	35	1,5	6		NO	YES	NO	NO
		1,4301	42	1,5	6		NO	YES	NO	NO
		1,4301	54	1,5	6		NO	YES	NO	NO
		1,4301	76,1	2	6		NO	YES	NO	NO
Raw / Annealed		1,4301	88,9	2	6		NO	YES	NO	NO
		1,4301	108	2	6		NO	YES	NO	NO

RACCORDERIE

PRESS FITTINGS



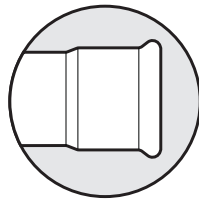
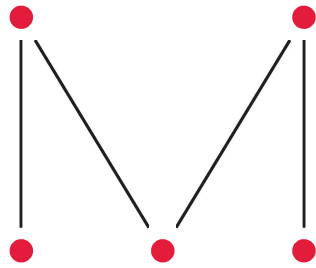

PROFILO M
M PROFILE

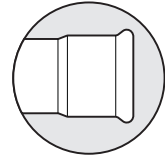

 ACCIAIO INOX AISI 316L STAINLESS STEEL AISI 316L		\emptyset 15-108
 Germany	  **	
 France	 	
 Austria	 *	
 Norway	  *	
 Sweden		
 Netherlands	 BRL 774-06	
 Switzerland		
 Denmark	  *	
 Russia		
 Italy	 	
 Czech Rep.	 *  AO 216 Fire testing	
 Australia	  *	
 Poland	   *	
 USA		

* Omologazione ottenuta direttamente dal distributore.
Approval obtained directly by our distributor.

** Gamma omologata **Vds** da $\emptyset 22$ a $\emptyset 108$ mm, valida esclusivamente per l'utilizzo abbinato di tubi e raccordi nostri fornitori.

Vds approved range from $\emptyset 22$ to $\emptyset 108$ mm, valid only for the combined use of our suppliers tubes and fittings.

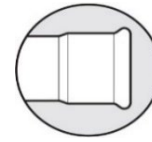

Manicotto
Coupling

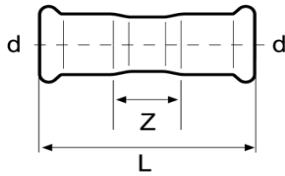

Code	d	L	Z		MOQ	€
S10AB-LBP	12	42	6	24	100	
S10AC-LBP	15	52	10	40	100	
S10AD-LBP	18	53	11	46	100	
S10AE-LBP	22	59	13	62	100	
S10AF-LBP	28	61	13	78	100	
S10AG-LBP	35	72	18	107	60	
S10AH-LBP	42	79	15	148	30	
S10AJ-LBP	54	90	16	210	30	
S10AK	76,1	143	33	646	5	
S10AL	88,9	163	37	792	5	
S10AM	108	196	42	1.263	5	



Manicotto di riduzione MF
Reducer with plain end

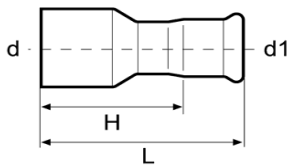

Code	d-d1	L	H		MOQ	€
S12CB-LBP	15-12	53	35	30	100	
S12DB-LBP	18-12	60	42	37	100	
S12DC-LBP	18-15	56	35	41	100	
S12EB-LBP	22-12	60	42	42	100	
S12EC-LBP	22-15	61	40	46	100	
S12ED-LBP	22-18	59	38	49	100	
S12FC-LBP	28-15	74	53	65	80	
S12FD-LBP	28-18	77	56	70	80	
S12FE-LBP	28-22	66	43	68	100	
S12GC-LBP	35-15	83	62	86	30	
S12GD-LBP	35-18	86	65	90	30	
S12GE-LBP	35-22	78	55	90	80	
S12GF-LBP	35-28	68	44	88	80	
S12HC-LBP	42-15	97	76	114	20	
S12HD-LBP	42-18	100	79	119	20	
S12HE-LBP	42-22	92	69	120	30	
S12HF-LBP	42-28	99	75	138	30	
S12HG-LBP	42-35	79	52	123	30	
S12JC-LBP	54-15	108	87	160	15	
S12JD-LBP	54-18	111	90	165	15	
S12JE-LBP	54-22	110	87	169	15	
S12JF-LBP	54-28	102	78	170	20	
S12JG-LBP	54-35	117	90	207	20	
S12JH-LBP	54-42	94	62	185	20	
S12KH-LBP	76,1-42	154	122	466	5	
S12KJ-LBP	76,1-54	142	106	469	5	
S12LJ-LBP	88,9-54	157	121	581	5	
S12LK	88,9-76,1	158	103	705	5	
S12MJ-LBP	108-54	206	169	874	5	
S12MK	108-76,1	199	144	989	5	
S12ML	108-88,9	196	133	1.038	5	

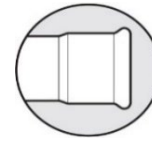

Manicotto passante
Slip Coupling

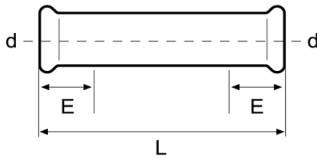

Code	d	L	E	 g	MOQ	€
S11AB-LBP	12	56	20	33	100	
S11AC-LBP	15	73	24	56	100	
S11AD-LBP	18	77	25	63	50	
S11AE-LBP	22	83	27	84	50	
S11AF-LBP	28	92	28	114	50	
S11AG-LBP	35	101	31	153	50	
S11AH-LBP	42	118	35	218	30	
S11AJ-LBP	54	142	40	327	20	
S11AK	76,1	232	60	1011	5	
S11AL	88,9	262	70	1.327	5	
S11AM	108	312	80	1.928	5	



Curva 90°
Bend 90°

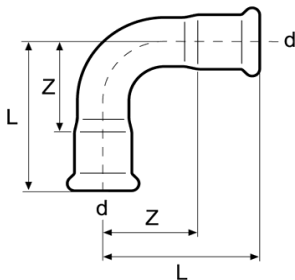

Code	d	Radius	L	Z	 g	MOQ	€
S20AC-LBP	15	1,5	48	27	56	100	
S20AD-LBP	18	1,5	53	32	70	100	
S20AE-LBP	22	1,5	61	38	100	100	
S20AF-LBP	28	1,5	72	48	144	60	
S20AG-LBP	35	1,5	87	60	206	60	
S20AH-LBP	42	1,5	115	83	330	30	
S20AJ-LBP	54	1,5	142	105	503	20	
S20ZB-LBP	12	1,2	42	24	36	100	
S20ZC-LBP	15	1,2	42	21	51	100	
S20ZD-LBP	18	1,2	45	24	62	100	
S20ZE-LBP	22	1,2	53	30	88	100	
S20ZF-LBP	28	1,2	61	37	125	60	
S20ZG-LBP	35	1,2	72	45	180	60	
S20ZH-LBP	42	1,2	87	55	262	30	
S20ZJ-LBP	54	1,2	107	70	405	20	
S20ZK	76,1	1,2	154	99	1.180	5	
S20ZL	88,9	1,2	174	111	1.490	5	
S20ZM	108	1,2	215	138	2.222	5	

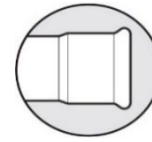

Curva 90° MF
Bend 90° with plain end

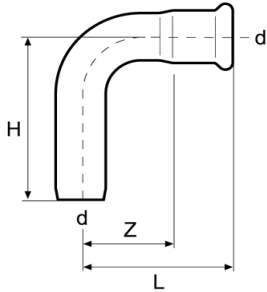

Code	d	Radius	L	H	Z		MOQ	€
S21AC-LBP	15	1,5	48	57	27	58	100	
S21AD-LBP	18	1,5	53	62	32	73	100	
S21AE-LBP	22	1,5	61	70	38	102	100	
S21AF-LBP	28	1,5	72	80	48	147	50	
S21AG-LBP	35	1,5	87	94	60	206	50	
S21AH-LBP	42	1,5	115	125	83	331	20	
S21AJ-LBP	54	1,5	142	150	105	513	20	
S21ZB-LBP	12	1,2	42	52	24	40	100	
S21ZC-LBP	15	1,2	42	52	21	50	100	
S21ZD-LBP	18	1,2	45	53	24	61	100	
S21ZE-LBP	22	1,2	53	63	30	88	100	
S21ZF-LBP	28	1,2	61	71	37	126	50	
S21ZG-LBP	35	1,2	72	80	45	180	50	
S21ZH-LBP	42	1,2	87	97	55	258	20	
S21ZJ-LBP	54	1,2	107	116	70	376	20	
S21ZK	76,1	1,2	154	171	99	1.127	5	
S21ZL	88,9	1,2	174	191	111	1.486	5	
S21ZM	108	1,2	215	234	138	2.220	5	



Curva 45°
Bend 45°

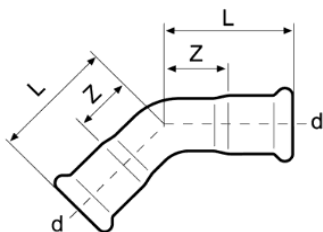

Code	d	Radius	L	Z		MOQ	€
S22AC-LBP	15	1,5	36	15	51	100	
S22AD-LBP	18	1,5	38	17	58	100	
S22AE-LBP	22	1,5	43	20	80	100	
S22AF-LBP	28	1,5	48	24	118	50	
S22AG-LBP	35	1,5	59	32	165	50	
S22AH-LBP	42	1,5	77	45	258	20	
S22AJ-LBP	54	1,5	88	51	374	20	
S22ZB-LBP	12	1,2	32	14	34	100	
S22ZC-LBP	15	1,2	31	10	44	100	
S22ZD-LBP	18	1,2	31	10	51	100	
S22ZE-LBP	22	1,2	37	14	72	100	
S22ZF-LBP	28	1,2	41	17	98	50	
S22ZG-LBP	35	1,2	49	22	162	50	
S22ZH-LBP	42	1,2	57	25	201	20	
S22ZJ-LBP	54	1,2	70	33	309	20	
S22ZK	76,1	1,2	100	45	846	5	
S22ZL	88,9	1,2	112	49	1.008	5	
S22ZM	108	1,2	139	62	1.674	5	

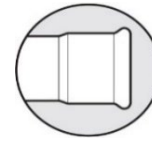

Curva 45° MF
Bend 45° with plain end

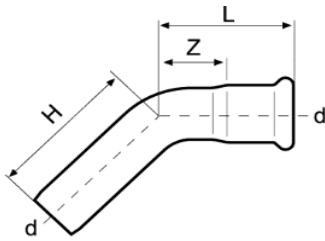

Code	d	Radius	L	H	Z		MOQ	€
S23AC-LBP	15	1,5	36	43	15	48	100	
S23AD-LBP	18	1,5	38	43	17	58	100	
S23AE-LBP	22	1,5	43	50	20	81	100	
S23AF-LBP	28	1,5	48	57	24	116	50	
S23AG-LBP	35	1,5	59	66	32	166	50	
S23AH-LBP	42	1,5	77	86	45	258	20	
S23AJ-LBP	54	1,5	88	97	51	376	20	
S23ZB-LBP	12	1,2	32	42	14	34	100	
S23ZC-LBP	15	1,2	32	41	11	43	100	
S23ZD-LBP	18	1,2	31	35	10	49	100	
S23ZE-LBP	22	1,2	38	46	15	71	100	
S23ZF-LBP	28	1,2	42	51	18	99	50	
S23ZG-LBP	35	1,2	49	55	22	140	50	
S23ZH-LBP	42	1,2	57	66	25	199	20	
S23ZJ-LBP	54	1,2	70	76	33	302	20	
S23ZK	76,1	1,2	100	115	45	847	5	
S23ZL	88,9	1,2	112	136	49	1.151	5	
S23ZM	108	1,2	139	158	62	1.672	5	



Adattatore 90° - filetto femmina
Bend adaptor 90° with female thread

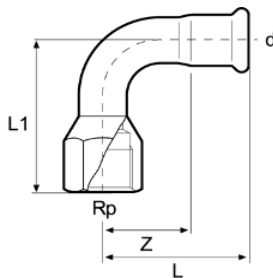

Code	d - Rp	L	L1	Z		MOQ	€
S82PC-LBP	15-Rp $\frac{1}{2}$	48	58	27	84	20	
S82PD-LBP	18-Rp $\frac{1}{2}$	53	59	32	86	20	
S82QE-LBP	22-Rp $\frac{3}{4}$	61	68	38	136	20	
S82RF-LBP	28-Rp1	72	80	48	198	20	
S82SG-LBP	35-Rp1 $\frac{1}{4}$	87	94	60	312	15	



Adattatore 90° - filetto maschio
Bend adaptor 90° with male thread

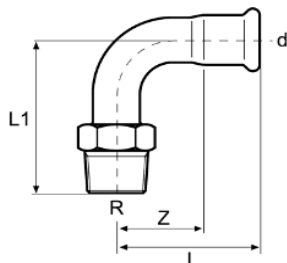

Code	d - R	L	L1	Z		MOQ	€
S83PC-LBP	15-R $\frac{1}{2}$	48	57	27	78	20	
S83PD-LBP	18-R $\frac{1}{2}$	53	60	32	86	20	
S83QE-LBP	22-R $\frac{3}{4}$	61	68	38	127	20	
S83RF-LBP	28-R1	72	81	48	205	20	
S83SG-LBP	35-R1 $\frac{1}{4}$	87	93	60	302	15	
S83TH-LBP	42-R1 $\frac{1}{2}$	115	116	83	411	15	
S83VJ-LBP	54-R2	142	143	105	716	15	

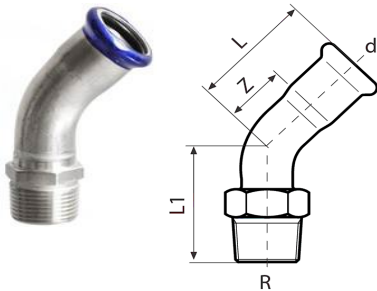
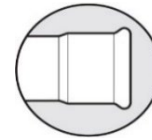

Adattatore 45° - filetto maschio
Bend adaptor 45° with male thread

Code	d - R	L	L1	Z		MOQ	€
S85PC-LBP	15-R 1/2	36	38	15	70	20	
S85PD-LBP	18-R 1/2	38	40	17	75	20	
S85QE-LBP	22-R 3/4	43	44	20	103	20	

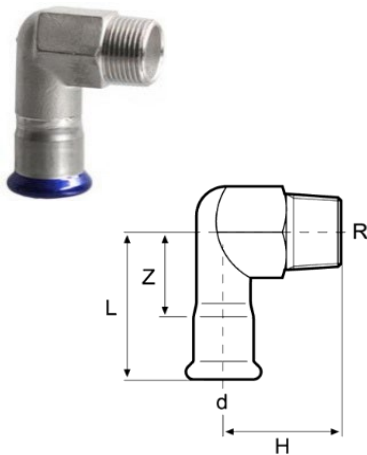

Gomito misto - filetto maschio
Elbow adaptor 90° with male thread

Code	d - R	L	H	Z		MOQ	€
S31PC-LBP	15-R 1/2	54	37	33	108	80	
S31QC-LBP	15-R 3/4	63	39	42	166	50	
S31PD-LBP	18-R 1/2	54	37	33	115	50	
S31QD-LBP	18-R 3/4	67	39	46	171	30	
S31QE-LBP	22-R 3/4	58	39	35	170	50	
S31RF-LBP	28-R1	65	44	41	294	50	
S31SG-LBP	35-R1 1/4	73	49	46	468	30	
S31TH-LBP	42-R1 1/2	82	54	50	578	15	
S31VJ-LBP	54-R2	92	60	55	1.011	15	

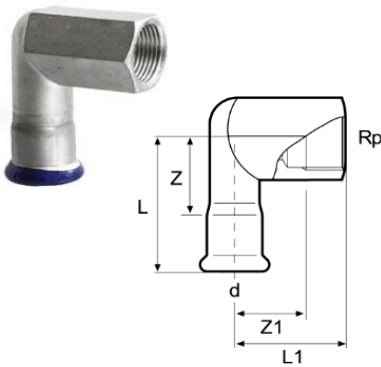

Gomito misto - filetto femmina
Elbow adaptor 90° with female thread

Code	d - Rp	L	L1	Z	Z1		MOQ	€
S30PC-LBP	15-Rp 1/2	54	37	33	25	128	80	
S30PD-LBP	18-Rp 1/2	54	39	33	27	141	60	
S30QD-LBP	18-Rp 3/4	66	46	45	33	226	50	
S30QE-LBP	22-Rp 3/4	58	46	35	33	184	50	
S30RF-LBP	28-Rp1	65	54	41	38	408	50	
S30SG-LBP	35-Rp1 1/4	73	63	46	46	589	30	

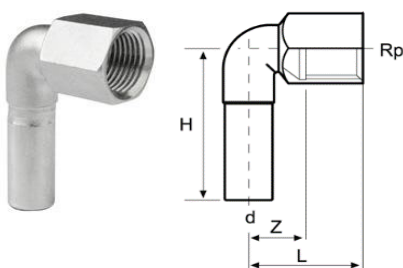

Gomito misto 90° MF
Elbow adaptor 90° with female thread and plain end

Code	d - Rp	L	H	Z		MOQ	€
S34PC	15-Rp 1/2	35	53	23	72	50	

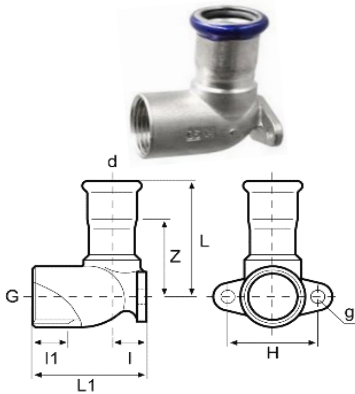
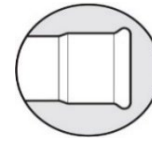

Gomito misto con flangia
90° female elbow adaptor with wall plate

Code	d - G (ISO 228)	L	L1	Z	I	I1	H	g		MOQ	€
S32PC-LBP	15-G $\frac{1}{2}$	47	43	26	13	13	34	5	112	80	
S32PD-LBP	18-G $\frac{1}{2}$	47	43	26	13	13	34	5	107	60	
S32QE-LBP	22-G $\frac{3}{4}$	52	51	29	17	15	40	6	163	60	

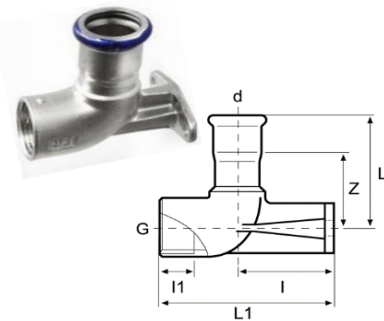

Gomito misto con flangia lunga
90° female elbow adaptor with long wall plate

Code	d - G (ISO 228)	L	I	L1	Z	I1		MOQ	€
S33PC-LBP	15-G $\frac{1}{2}$	47	35	65	26	13	161	50	
S33PD-LBP	18-G $\frac{1}{2}$	47	35	65	26	13	156	50	
S33QE-LBP	22-G $\frac{3}{4}$	52	31	65	29	15	194	50	

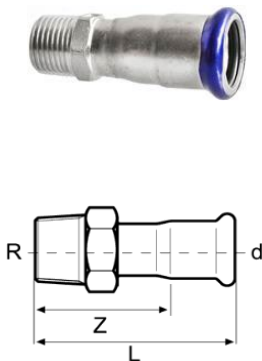

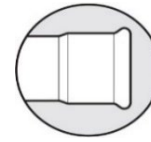

Manicotto misto - filetto maschio
Adaptor with male thread

Code	d - R	L	Z		MOQ	€
S81NB-LBP	12-R $\frac{3}{8}$	48	30	45	100	
S81PB-LBP	12-R $\frac{1}{2}$	51	33	61	100	
S81NC-LBP	15-R $\frac{3}{8}$	50	29	50	100	
S81PC-LBP	15-R $\frac{1}{2}$	53	32	58	100	
S81QC-LBP	15-R $\frac{3}{4}$	64	43	75	50	
S81PD-LBP	18-R $\frac{1}{2}$	54	33	59	100	
S81QD-LBP	18-R $\frac{3}{4}$	56	35	72	50	
S81PE-LBP	22-R $\frac{1}{2}$	68	45	76	100	
S81QE-LBP	22-R $\frac{3}{4}$	58	35	79	100	
S81RE-LBP	22-R1	72	49	130	100	
S81QF-LBP	28-R $\frac{3}{4}$	74	50	102	80	
S81RF-LBP	28-R1	64	40	130	100	
S81SF-LBP	28-R1 $\frac{1}{4}$	80	56	196	50	
S81RG-LBP	35-R1	83	56	163	50	
S81SG-LBP	35-R1 $\frac{1}{4}$	71	44	190	50	
S81TG-LBP	35-R1 $\frac{1}{2}$	84	57	223	30	
S81SH-LBP	42-R1 $\frac{1}{4}$	94	62	241	20	
S81TH-LBP	42-R1 $\frac{1}{2}$	76	44	224	20	
S81TJ-LBP	54-R1 $\frac{1}{2}$	106	69	302	20	
S81VJ-LBP	54-R2	87	50	405	20	
S81XK	76,1-R 2 $\frac{1}{2}$	125	70	889	5	
S81YL	88,9-R 3	140	77	1.272	5	

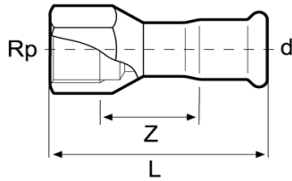

Manicotto misto - filetto femmina
Adaptor with female thread



Code	d - Rp	L	Z		MOQ	€
S80NB-LBP	12-Rp ³ / ₈	49	21	52	100	
S80PB-LBP	12-Rp ¹ / ₂	52	24	54	100	
S80PC-LBP	15-Rp ¹ / ₂	54	21	60	100	
S80QC-LBP	15-Rp ³ / ₄	67	33	91	60	
S80PD-LBP	18-Rp ¹ / ₂	52	19	60	100	
S80QD-LBP	18-Rp ³ / ₄	58	24	88	100	
S80PE-LBP	22-Rp ¹ / ₂	52	17	84	100	
S80QE-LBP	22-Rp ³ / ₄	57	21	88	100	
S80RE-LBP	22-Rp1	70	31	122	80	
S80QF-LBP	28-Rp ³ / ₄	73	36	112	80	
S80RF-LBP	28-Rp1	63	23	123	80	
S80SF-LBP	28-Rp1 ¹ / ₄	81	40	205	50	
S80RG-LBP	35-Rp1	82	39	150	50	
S80SG-LBP	35-Rp1 ¹ / ₄	72	28	203	50	
S80TG-LBP	35-Rp1 ¹ / ₂	83	39	294	50	
S80SH-LBP	42-Rp1 ¹ / ₄	95	46	251	20	
S80TH-LBP	42-Rp1 ¹ / ₂	75	26	296	30	
S80TJ-LBP	54-Rp1 ¹ / ₂	105	51	373	20	
S80VJ-LBP	54-Rp2	85	26	400	20	



Codolo - filetto maschio
Adaptor with male thread and plain end

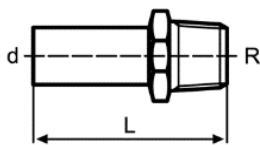

Code	d - R	L		MOQ	€
S87PC	15-R ¹ / ₂	70	60	100	
S87PD	18-R ¹ / ₂	70	63	100	
S87QE	22-R ³ / ₄	75	78	100	
S87RF	28-R1	75	124	80	
S87SG	35-R1 ¹ / ₄	80	195	80	
S87TH	42-R1 ¹ / ₂	91	233	50	
S87VJ	54-R2	102	419	50	



Codolo - filetto femmina
Adaptor with female thread and plain end

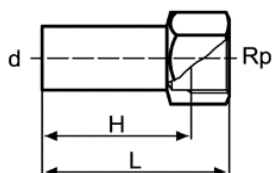

Code	d - Rp	H	L		MOQ	€
S86PC	15-Rp ¹ / ₂	133	148	83	100	
S86PD	18-Rp ¹ / ₂	133	148	90	100	
S86QD	18-Rp ³ / ₄	131	148	115	100	
S86PE	22-Rp ¹ / ₂	137	152	135	100	
S86QE	22-Rp ³ / ₄	136	152	137	100	
S86RF	28-Rp1	91	110	147	80	
S86SG	35-Rp1 ¹ / ₄	89	110	242	80	
S86TH	42-Rp1 ¹ / ₂	90	110	335	50	
S86VJ	54-Rp2	94	120	453	50	

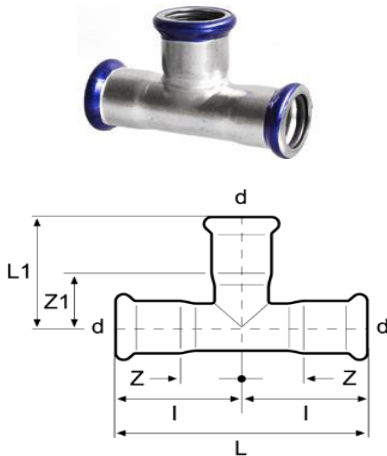
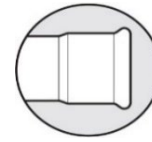

Tee
T-piece equal

Code	d	L	L1	Z	Z1	I		MOQ	€
S40AB-LBP	12	56	33	10	15	28	49	100	
S40AC-LBP	15	73	35	15	14	36	71	100	
S40AD-LBP	18	77	37	17	16	38	84	100	
S40AE-LBP	22	83	41	18	18	41	110	100	
S40AF-LBP	28	92	47	22	23	46	151	80	
S40AG-LBP	35	101	53	23	26	50	200	50	
S40AH-LBP	42	118	61	27	29	59	281	20	
S40AJ-LBP	54	142	74	34	37	71	419	20	
S40AK	76,1	232	110	61	55	116	1.274	5	
S40AL	88,9	262	129	68	66	131	1.691	5	
S40AM	108	312	154	79	77	156	2.458	5	

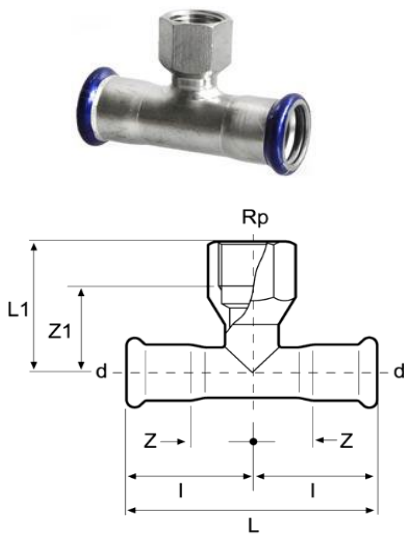

Adattatore tee - filetto femmina
T-piece with female thread

Code	d - Rp - d	L	L1	Z	Z1	I		MOQ	€
S42PC-LBP	15-Rp $\frac{1}{2}$ -15	73	37	15	25	36	84	100	
S42PD-LBP	18-Rp $\frac{1}{2}$ -18	77	39	17	27	38	102	80	
S42QD-LBP	18-Rp $\frac{3}{4}$ -18	77	43	17	30	38	127	50	
S42PE-LBP	22-Rp $\frac{1}{2}$ -22	83	41	18	29	41	122	100	
S42QE-LBP	22-Rp $\frac{3}{4}$ -22	83	41	18	28	41	139	80	
S42PF-LBP	28-Rp $\frac{1}{2}$ -28	92	44	22	32	46	153	80	
S42QF-LBP	28-Rp $\frac{3}{4}$ -28	92	45	22	32	46	170	50	
S42RF-LBP	28-Rp1-28	92	48	22	32	46	194	30	
S42PG-LBP	35-Rp $\frac{1}{2}$ -35	101	46	23	34	50	189	50	
S42QG-LBP	35-Rp $\frac{3}{4}$ -35	101	47	23	34	50	206	50	
S42RG-LBP	35-Rp1-35	101	51	23	35	50	229	20	
S42SG-LBP	35-Rp1 $\frac{1}{4}$ -35	101	55	23	38	50	295	20	
S42PH-LBP	42-Rp $\frac{1}{2}$ -42	118	47	27	35	59	264	20	
S42QH-LBP	42-Rp $\frac{3}{4}$ -42	118	51	27	38	59	268	20	
S42RH-LBP	42-Rp1-42	118	55	27	39	59	292	20	
S42TH-LBP	42-Rp1 $\frac{1}{2}$ -42	118	58	27	41	59	427	20	
S42PJ-LBP	54-Rp $\frac{1}{2}$ -54	142	53	34	41	71	372	15	
S42QJ-LBP	54-Rp $\frac{3}{4}$ -54	142	58	34	45	71	376	15	
S42RJ-LBP	54-Rp1-54	142	62	34	46	71	400	15	
S42VJ-LBP	54-Rp2-54	142	71	34	49	71	608	15	
S42QK	76,1-Rp $\frac{3}{4}$ -76,1	232	69	61	56	116	1.038	5	
S42VK	76,1-Rp2-76,1	232	82	61	60	116	1.264	5	
S42QL	88,9-Rp $\frac{3}{4}$ -88,9	262	77	68	64	131	1.353	5	
S42RL	88,9-Rp1-88,9	262	81	68	65	131	1.376	5	
S42VL	88,9-Rp2-88,9	262	90	68	68	131	1.579	5	
S42QM	108-Rp $\frac{3}{4}$ -108	312	86	79	73	156	1.946	5	
S42RM	108-Rp1-108	312	90	79	74	156	1.970	5	
S42TM	108-Rp1 $\frac{1}{2}$ -108	312	94	79	71	156	2.103	5	
S42VM	108-Rp2-108	312	99	79	77	156	2.171	5	

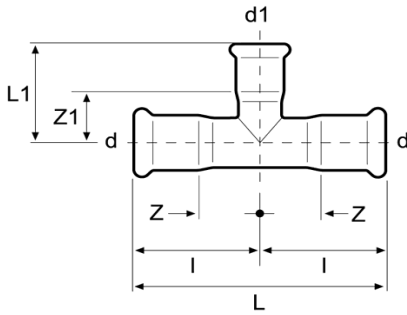
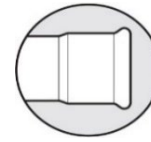

Tee ridotto
T-piece reduced

Code	d - d1 - d	L	L1	Z	Z1	I		MOQ	€
S41BC-LBP	15-12-15	73	34	15	16	36	67	100	
S41BD-LBP	18-12-18	77	36	17	18	38	77	100	
S41CD-LBP	18-15-18	77	37	17	16	38	81	100	
S41BE-LBP	22-12-22	83	38	18	20	41	97	100	
S41CE-LBP	22-15-22	83	39	18	18	41	102	100	
S41DE-LBP	22-18-22	83	40	18	19	41	104	100	
S41CF-LBP	28-15-28	92	42	22	21	46	132	80	
S41DF-LBP	28-18-28	92	43	22	22	46	135	80	
S41EF-LBP	28-22-28	92	45	22	22	46	142	80	
S41CG-LBP	35-15-35	101	44	23	23	50	167	50	
S41DG-LBP	35-18-35	101	45	23	24	50	169	50	
S41EG-LBP	35-22-35	101	47	23	24	50	178	50	
S41FG-LBP	35-28-35	101	50	23	26	50	186	50	
S41CH-LBP	42-15-42	118	49	27	28	59	231	20	
S41DH-LBP	42-18-42	118	49	27	28	59	233	20	
S41EH-LBP	42-22-42	118	51	27	28	59	240	30	
S41FH-LBP	42-28-42	118	54	27	30	59	250	30	
S41GH-LBP	42-35-42	118	57	27	30	59	261	30	
S41CJ-LBP	54-15-54	142	54	34	33	71	338	15	
S41DJ-LBP	54-18-54	142	56	34	35	71	341	15	
S41EJ-LBP	54-22-54	142	58	34	35	71	348	20	
S41FJ-LBP	54-28-54	142	61	34	37	71	358	15	
S41GJ-LBP	54-35-54	142	65	34	38	71	371	15	
S41HJ-LBP	54-42-54	142	69	34	37	71	390	15	
T41DK-LBP	76,1-18-76,1	232	68	61	47	116	1.004	5	
S41EK-LBP	76,1-22-76,1	232	69	61	46	116	1010	5	
S41FK-LBP	76,1-28-76,1	232	72	61	48	116	1.019	5	
S41GK-LBP	76,1-35-76,1	232	76	61	49	116	1032	5	
S41HK-LBP	76,1-42-76,1	232	80	61	48	116	1.049	5	
S41JK-LBP	76,1-54-76,1	232	85	61	48	116	1074	5	
S41EL-LBP	88,9-22-88,9	262	77	68	54	131	1.325	5	
S41FL-LBP	88,9-28-88,9	262	80	68	56	131	1334	5	
S41GL-LBP	88,9-35-88,9	262	84	68	57	131	1.347	5	
S41HL-LBP	88,9-42-88,9	262	88	68	56	131	1365	5	
S41JL-LBP	88,9-54-88,9	262	93	68	56	131	1.392	5	
S41KL	88,9-76,1-88,9	262	118	68	63	131	1588	5	
S41EM-LBP	108-22-108	312	86	79	63	156	1.918	5	
S41FM-LBP	108-28-108	312	89	79	65	156	1927	5	
S41GM-LBP	108-35-108	312	93	79	66	156	1.940	5	
S41HM-LBP	108-42-108	312	97	79	65	156	1957	5	
S41JM-LBP	108-54-108	312	102	79	65	156	1.983	5	
S41KM	108-76,1-108	312	127	79	72	156	2177	5	
S41LM	108-88,9-108	312	138	79	75	156	2.275	5	

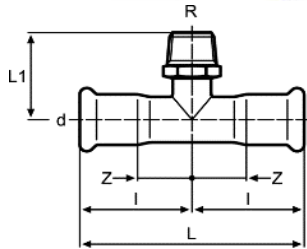
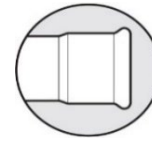

Adattatore tee - filetto maschio
T-piece with male thread

Code	d - R - d	L	L1	Z	I		MOQ	€
S43PC-LBP	15-R $\frac{1}{2}$ -15	73	36	15	36	90	100	
S43NC-LBP	15-R $\frac{3}{4}$ -15	73	34	16	36	82	100	
S43PD-LBP	18-R $\frac{1}{2}$ -18	77	38	17	38	94	100	
S43QD-LBP	18-R $\frac{3}{4}$ -18	77	40	17	38	110	100	
S43QE-LBP	22-R $\frac{3}{4}$ -22	83	42	18	41	130	100	
S43RF-LBP	28-R1-28	92	49	22	46	201	80	
S43SG-LBP	35-R1 $\frac{1}{4}$ -35	101	54	23	50	284	50	

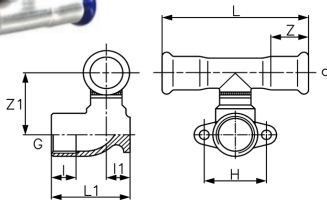

Tee disassato
Misaligned T-piece

Code	d - G (ISO 228)	L	L1	Z	Z1	H	I	I1		MOQ	€
S48PC-LBP	15-G $\frac{1}{2}$	73	43	21	30	34	13	13	144	100	
S48PD-LBP	18-G $\frac{1}{2}$	77	43	21	32	34	13	13	146	100	

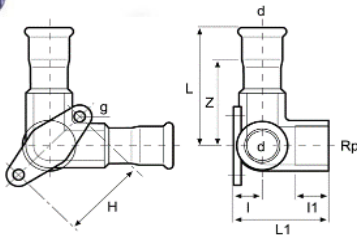

Trivio 90° filetto femmina con flangia
Double tap connector 90°/90° with female thread

Code	d - Rp	L	L1	I	I1	Z	H	g		MOQ	€
S36PC-LBP	15-Rp $\frac{1}{2}$	57	43	13	15	36	39	5	166	50	

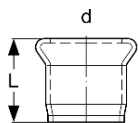

Mezzo manicotto a saldare
Welding joint

Code	d	L		MOQ	€
S17AC-LBP	15	26	20	200	
S17AD-LBP	18	26	23	200	
S17AE-LBP	22	28	30	200	
S17AF-LBP	28	31	40	150	
S17AG-LBP	35	35	54	150	
S17AH-LBP	42	39	75	100	
S17AJ-LBP	54	44	106	100	
S17AK	76	69	316	50	
S17AL	89	80	424	50	
S17AM	108	96	621	50	

Fornito senza sleeve e con guarnizione a parte.
 Per conoscere le condizioni di impiego di questo
 componente siete pregati di contattare il nostro
 ufficio tecnico.

Supplied without sleeve and with separate gasket.
 Correct conditions of use have to be requested
 from our technical department.

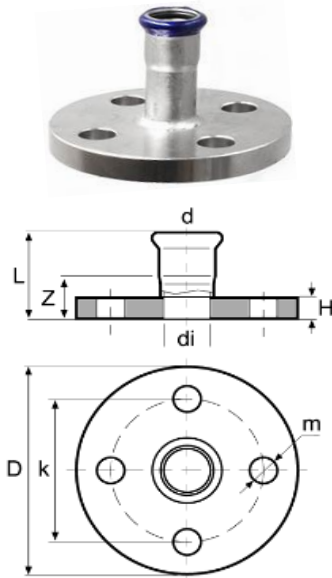
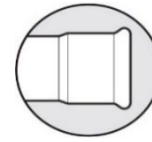

Flangia con bicchiere PN 10/16
Flange with pressing socket PN 10/16

Code	d	D	di	L	H	m	k	Z		MOQ	€
S52AC-LBP	15	95	14	53	11	14	65	32	591	20	
S52AD-LBP	18	95	17	57	11	14	65	36	591	20	
S52AE-LBP	22	105	21	60	12	14	75	37	792	20	
S52AF-LBP	28	115	27	65	14	14	85	41	1.101	20	
S52AG-LBP	35	140	32	70	15	18	100	43	1.724	20	
S52AH-LBP	42	150	39	77	16	18	110	45	2.105	15	
S52AJ-LBP	54	165	51	87	18	18	125	50	2.818	15	
S52AK	76,1	185	72	128	18	18	145	73	3.636	5	
S52AL	88,9	200	85	145	20	18	160	82	4.453	5	
S52AM	108	220	104	169	20	18	180	92	5.346	5	

I diametri 88,9 e 108 hanno 8 fori

Diameters 88,9 and 108 are with 8 holes

Durchmesser 88,9 und 108 mit 8 Befestigungslöcher

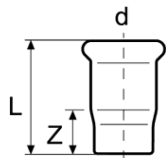

Tappo femmina
Cap

Code	d	L	Z		MOQ	€
S50AC-LBP	15	37	16	28	100	
S50AD-LBP	18	39	18	33	50	
S50AE-LBP	22	42	19	45	50	
S50AF-LBP	28	46	22	63	50	
S50AG-LBP	35	51	24	78	50	
S50AH-LBP	42	59	27	119	20	
S50AJ-LBP	54	72	35	183	20	
S50AK	76,1	95	40	441	5	
S50AL	88,9	107	44	544	5	
S50AM	108	129	52	862	5	

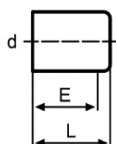

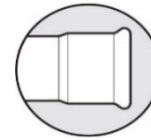

Tappo maschio
Plug

Code	d	E	L		MOQ	€
S51AC	15	33	42	16	100	
S51AD	18	33	40	18	50	
S51AE	22	34	43	30	50	
S51AF	28	36	47	42	50	
S51AG	35	40	49	70	50	
S51AH	42	44	55	96	20	
S51AJ	54	49	62	144	20	
S51AK	76,1	65	75	328	5	
S51AL	88,9	72	90	480	5	
S51AM	108	87	103	648	5	



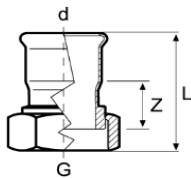

Girella con dado in ottone o acciaio inox e guarnizione piatta in EPDM Adaptor with union nut in brass/stainless steel and EPDM flat seal

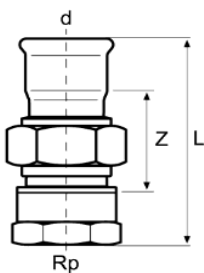

Code	d - G (ISO 228)	Dado Nut	L	Z		MOQ	€
S60PC-LBP	15-G $\frac{1}{2}$	Ottone Brass	52	22	65	50	
S60QC-LBP	15-G $\frac{3}{4}$		50	22	90	50	
S60SC-LBP	15-G1 $\frac{1}{4}$		51	20	190	15	
S60QD-LBP	18-G $\frac{3}{4}$		36	8	66	50	
S60RE-LBP	22-G1		39	7	106	50	
S60RF-LBP	28-G1		60	26	159	50	
S60SF-LBP	28-G1 $\frac{1}{4}$		44	10	168	50	
S60TF-LBP	28-G1 $\frac{1}{2}$		73	38	170	50	
S60TG-LBP	35-G1 $\frac{1}{2}$		48	11	260	20	
S60UH-LBP	42-G1 $\frac{3}{4}$		53	9	292	20	
S60VH-LBP	42-G2	57	11	509	20		
S60WJ-LBP	54-G2 $\frac{3}{8}$	61	10	454	20		
S61QC-LBP	15-G $\frac{3}{4}$	Inox Stainless steel	51	22	100	50	
S61SC-LBP	15-G1 $\frac{1}{4}$		52	20	90	15	
S61QD-LBP	18-G $\frac{3}{4}$		38	8	70	50	
S61RE-LBP	22-G1		39	7	115	50	
S61SF-LBP	28-G1 $\frac{1}{4}$		44	10	165	50	
S61TF-LBP	28-G1 $\frac{1}{2}$		73	38	308	50	
S61TG-LBP	35-G1 $\frac{1}{2}$		48	11	275	20	
S61UH-LBP	42-G1 $\frac{3}{4}$		53	9	285	20	
S61WJ-LBP	54-G2 $\frac{3}{8}$		61	10	420	20	

Girella con dado in ottone o acciaio inox e raccordo femmina e guarnizione piatta in EPDM Adaptor union with female thread, brass/stainless steel nut and EPDM flat seal



Code	d - Rp	Dado Nut	L	Z		MOQ	€
S62PC-LBP	15-Rp $\frac{1}{2}$	Ottone Brass	73	41	150	15	
S62QC-LBP	15-Rp $\frac{3}{4}$		76	43	205	15	
S62PD-LBP	18-Rp $\frac{1}{2}$		59	27	132	15	
S62QD-LBP	18-Rp $\frac{3}{4}$		62	29	190	15	
S62QE-LBP	22-Rp $\frac{3}{4}$		63	28	220	15	
S62RE-LBP	22-Rp1		67	30	270	15	
S62RF-LBP	28-Rp1		71	33	420	15	
S62SG-LBP	35-Rp1 $\frac{1}{4}$		77	34	520	15	
S62TH-LBP	42-Rp1 $\frac{1}{2}$		82	33	590	15	
S62VJ-LBP	54-Rp2		95	37	1080	15	
S63PC-LBP	15-Rp $\frac{1}{2}$	Inox Stainless steel	73	41	160	15	
S63QC-LBP	15-Rp $\frac{3}{4}$		76	43	220	15	
S63PD-LBP	18-Rp $\frac{1}{2}$		59	27	150	15	
S63QD-LBP	18-Rp $\frac{3}{4}$		62	29	205	15	
S63QE-LBP	22-Rp $\frac{3}{4}$		63	28	230	15	
S63RE-LBP	22-Rp1		67	30	280	15	
S63RF-LBP	28-Rp1		71	33	400	15	
S63SG-LBP	35-Rp1 $\frac{1}{4}$		77	34	462	15	
S63TH-LBP	42-Rp1 $\frac{1}{2}$		82	33	484	15	
S63VJ-LBP	54-Rp2		95	37	1035	15	

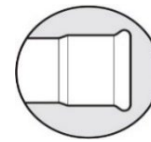

Girella con dado in ottone o acciaio inox e raccordo maschio e guarnizione piatta in EPDM
Adaptor union with male thread, brass/stainless steel nut and EPDM flat seal

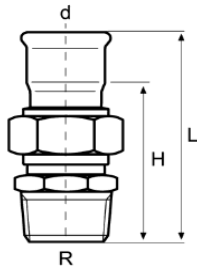

Code	d - R	Dado Nut	L	Z		MOQ	€	
S64PC-LBP	15-R $\frac{1}{2}$	Ottone Brass	77	56	150	15		
S64QC-LBP	15-R $\frac{3}{4}$		80	59	180	15		
S64PD-LBP	18-R $\frac{1}{2}$		63	42	135	15		
S64QD-LBP	18-R $\frac{3}{4}$		66	45	160	15		
S64PE-LBP	22-R $\frac{1}{2}$		67	44	240	15		
S64QE-LBP	22-R $\frac{3}{4}$		69	46	220	15		
S64RE-LBP	22-R1		73	50	280	15		
S64RF-LBP	28-R1		78	54	400	15		
S64SG-LBP	35-R1 $\frac{1}{4}$		85	59	540	15		
S64TH-LBP	42-R1 $\frac{1}{2}$		90	58	630	15		
S64VJ-LBP	54-R2		104	67	1.060	15		
S65PC-LBP	15-R $\frac{1}{2}$		Inox Stainless steel	77	56	165	15	
S65QC-LBP	15-R $\frac{3}{4}$			80	59	190	15	
S65PD-LBP	18-R $\frac{1}{2}$			63	42	150	15	
S65QD-LBP	18-R $\frac{3}{4}$	66		45	175	15		
S65PE-LBP	22-R $\frac{1}{2}$	67		44	250	15		
S65QE-LBP	22-R $\frac{3}{4}$	69		46	230	15		
S65RE-LBP	22-R1	73		50	290	15		
S65RF-LBP	28-R1	78		54	390	15		
S65SG-LBP	35-R1 $\frac{1}{4}$	85		59	540	15		
S65TH-LBP	42-R1 $\frac{1}{2}$	90		58	610	15		
S65VJ-LBP	54-R2	104		67	1.010	15		



Doppio raccordo con dado in ottone o acciaio inox e guarnizione piatta in EPDM
Straight union with press fittings on both ends, swivel nut in brass/st. steel and EPDM flat seal

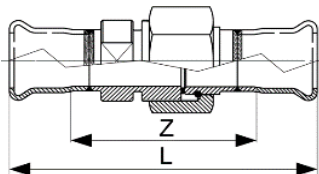

Code	d - G	Dado Nut Überwurf.	L	Z		MOQ	€	
S66QC-LBP	15-G $\frac{3}{4}$	Ottone Brass	99	57	176	15		
S66QD-LBP	18-G $\frac{3}{4}$		86	44	154	15		
S66RE-LBP	22-G1		94	48	247	15		
S66SF-LBP	28-G1 $\frac{1}{4}$		100	52	358	15		
S66TG-LBP	35-G1 $\frac{1}{2}$		110	57	579	15		
S66UH-LBP	42-G1 $\frac{1}{4}$		119	55	655	15		
S66WJ-LBP	54-G2 $\frac{3}{8}$		128	54	1001	15		
S68QC-LBP	15-G $\frac{3}{4}$		Inox Stainless steel	99	57	189	15	
S68QD-LBP	18-G $\frac{3}{4}$			86	44	168	15	
S68RE-LBP	22-G1			94	48	245	15	
S68SF-LBP	28-G1 $\frac{1}{4}$	100		52	374	15		
S68TG-LBP	35-G1 $\frac{1}{2}$	110		57	574	15		
S68UH-LBP	42-G1 $\frac{1}{4}$	119		55	635	15		
S68WJ-LBP	54-G2 $\frac{3}{8}$	128		54	955	15		

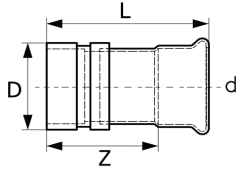
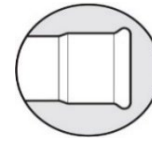

Raccordo di transizione per groove fittings
Transition joint for grooved fittings

Code	d - D	L	Z		MOQ	€
S96EF-LBP	28x33,7	87	63	171	30	
S96SG-LBP	35x42,4	94	67	239	20	
S96TH-LBP	42x48,3	105	73	298	20	
S96VJ-LBP	54x60,3	98	61	377	20	
S96KK	76,1x76,1	150	95	986	10	
S96LL	88,9x88,9	166	103	1.229	10	
S96ZM	108x114,4	184	107	1.393	10	

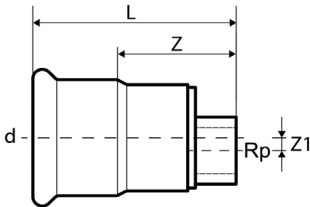

Tappo femmina di chiusura
Cap with female thread

Code	d - Rp	L	Z	Z1		MOQ	€
S00PF-LBP	28-Rp $\frac{1}{2}$	58	34	0	87	50	
S00PG-LBP	35-Rp $\frac{1}{2}$	66	39	2	111	50	
S00PH-LBP	42-Rp $\frac{1}{2}$	74	42	5	152	40	
S00PJ-LBP	54-Rp $\frac{1}{2}$	87	50	11	227	40	
S00PK	76,1-Rp $\frac{1}{2}$	86	31	22	438	30	
S00PL	88,9-Rp $\frac{1}{2}$	97	34	28	585	30	
S00PM	108-Rp $\frac{1}{2}$	112	35	38	851	30	

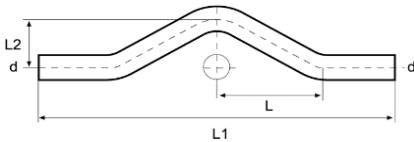

Scavalcamento
Pipe bridge
Überbogen

Code	d	L1	L2	L		MOQ	€
S76AC	15	202	38	65	76	15	
S76AD	18	236	43	68	104	15	
S76AE	22	233	40	68	202	10	
S76AF	28	303	64	93	350	10	

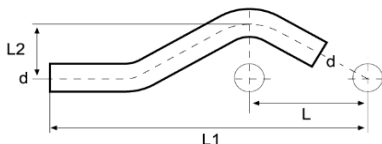

Scavalcamento corto
Pipe bridge short
Sprungbogen

Code	d	L1	L2	L		MOQ	€
S77AB	12	150	32	50	59	10	
S77AC	15	145	37	57	56	10	
S77AD	18	165	38	56	68	10	
S77AE	22	181	40	60	150	10	
S77AF	28	241	55	83	253	10	

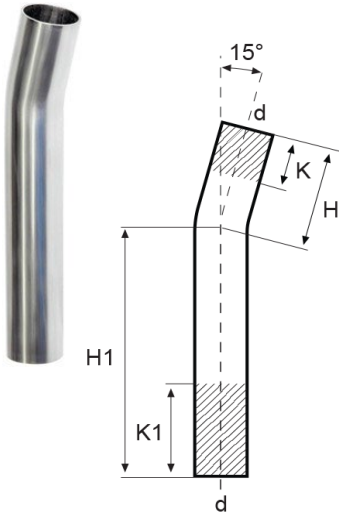
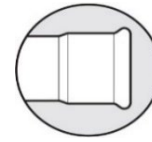

Tubo curvo 15°
Bend 15° with plain ends

Code	d	H1	H	K	K1		MOQ	€
S75AC	15	122	60	21	83	60	30	
S75AD	18	128	55	15	88	74	30	
S75AE	22	124	50	7	81	134	30	
S75AF	28	136	45	7	47	178	20	
S75AG	35	234	62	30	110	378	15	
S75AH	42	276	94	44	144	542	10	
S75AJ	54	337	117	65	165	884	10	
S75AK	76,1	230	226	65	65	1.580	5	
S75AL	88,9	260	240	80	80	1.954	5	
S75AM	108	291	222	95	95	2.516	5	

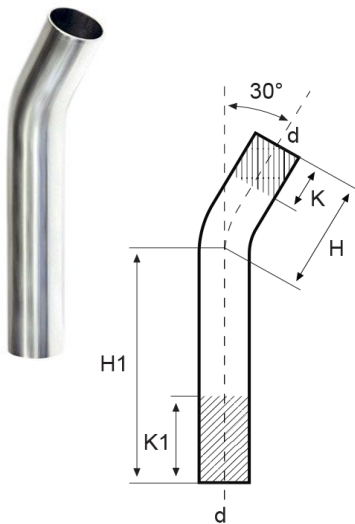

Tubo curvo 30°
Bend 30° with plain ends

Code	d	H1	H	K	K1		MOQ	€
S74AC	15	122	60	21	83	57	30	
S74AD	18	128	55	16	89	74	30	
S74AE	22	124	50	6	80	134	30	
S74AF	28	130	54	7	47	258	20	
S74AG	35	218	80	30	110	376	15	
S74AH	42	274	98	44	144	558	10	
S74AJ	54	324	137	65	165	912	10	
S74AK	76,1	200	202	66	66	1.350	5	
S74AL	88,9	262	264	80	80	2.110	5	
S74AM	108	259	272	95	95	2.622	5	

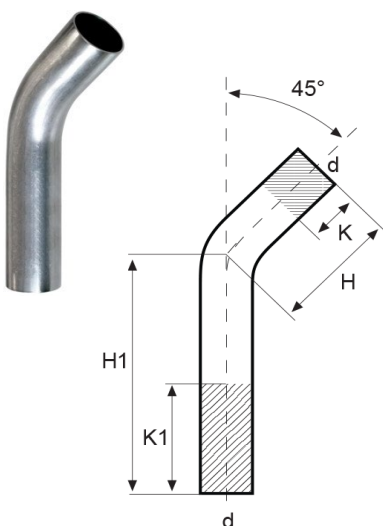

Tubo curvo 45°
Bend 45° with plain ends

Code	d	H1	H	K	K1		MOQ	€
S73AC	15	120	62	19	77	62	30	
S73AD	18	124	58	16	82	73	30	
S73AE	22	120	56	7	71	132	30	
S73AF	28	122	58	2	66	160	20	
S73AG	35	206	94	20	132	375	15	
S73AH	42	262	114	1	149	562	10	
S73AJ	54	321	146	37	212	906	10	
S73AK	76,1	225	225	69	69	1.618	5	
S73AL	88,9	267	267	103	103	2.078	5	
S73AM	108	293	293	66	66	2.988	5	

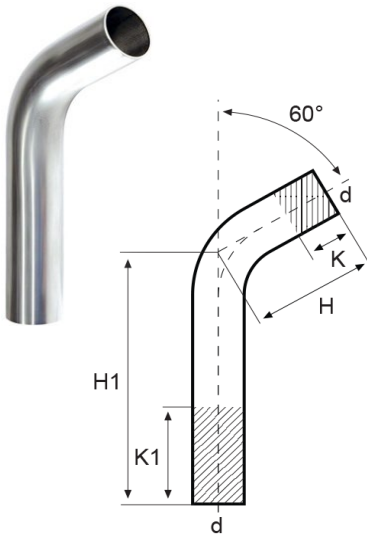
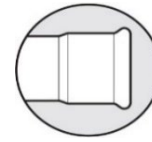

Tubo curvo 60°
Bend 60° with plain ends

Code	d	H1	H	K	K1		MOQ	€
S72AC	15	122	60	21	83	60	30	
S72AD	18	122	62	16	76	70	30	
S72AE	22	118	60	5	63	130	30	
S72AF	28	116	71	7	47	178	20	
S72AG	35	226	101	30	110	406	15	
S72AH	42	251	124	44	145	562	10	
S72AJ	54	308	162	65	165	884	10	
S72AK	76,1	219	223	70	70	1.476	5	
S72AL	88,9	250	257	80	80	1.970	5	
S72AM	108	288	298	95	95	2.844	5	

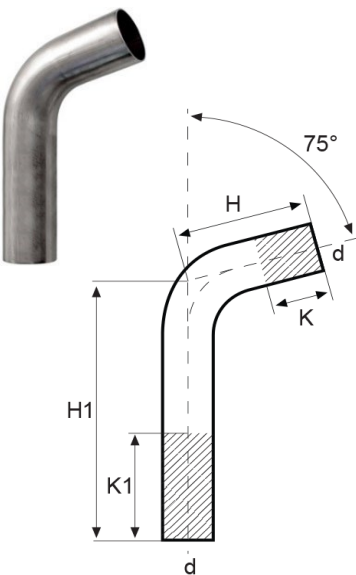

Tubo curvo 75°
Bend 75° with plain ends

Code	d	H1	H	K	K1		MOQ	€
S71AC	15	117	66	22	73	58	30	
S71AD	18	120	65	17	72	70	30	
S71AE	22	118	64	9	63	130	30	
S71AF	28	114	71	7	50	186	20	
S71AG	35	200	110	26	119	378	15	
S71AH	42	251	137	44	158	556	10	
S71AJ	54	305	178	60	187	893	10	
S71AK	76,1	240	240	62	62	1.556	5	
S71AL	88,9	280	280	90	90	2.130	5	
S71AM	108	330	330	45	45	3.360	5	

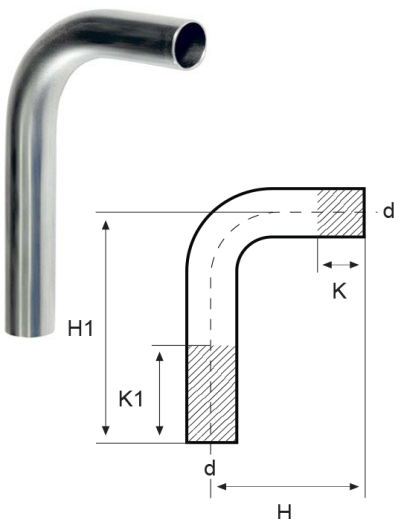

Tubo curvo 90°
Bend 90° with plain ends

Code	d	H1	H	K	K1		MOQ	€
S70AB	12	100	50	10	30	68	50	
S70AC	15	120	70	22	72	54	40	
S70AD	18	120	70	17	67	72	40	
S70AE	22	120	70	9	59	128	20	
S70AF	28	125	97	7	47	204	20	
S70AG	35	200	120	30	110	362	10	
S70AH	42	250	160	44	144	568	10	
S70AJ	54	305	200	65	165	908	10	
S70AK	76,1	250	250	62	62	1.668	5	
S70AL	88,9	291	291	90	90	2.022	5	
S70AM	108	364	364	45	45	3.200	5	

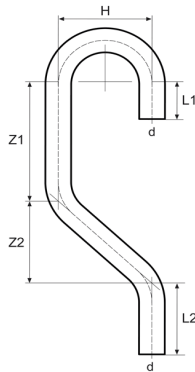
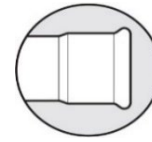

Tubo per aria compressa
Pipe for compressed air

Code	d	L1	L2	Z1	Z2	H	 g	MOQ	€
S69AC	15	30	45	130	65	70	145	40	
S69AD	18	35	66	130	77	76	195	40	
S69AE	22	35	67	127	77	80	292	30	
S69AF	28	40	82	134	97	100	552	30	

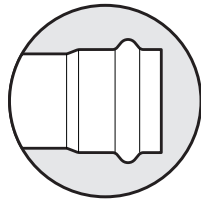
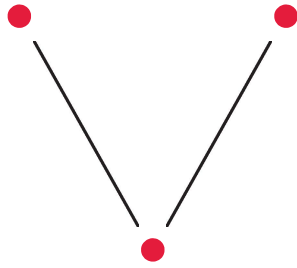

PROFILO V
V PROFILE

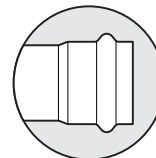

ACCIAIO INOX AISI 316L
STAINLESS STEEL AISI 316L
EDELSTAHL AISI 316L



Germany



Switzerland





Norway

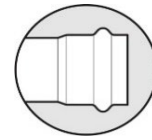

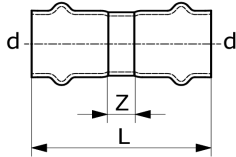

Manicotto
Coupling



Code	d	L	Z	 g	MOQ	€
S10ACVI-LBP	15	54	12	39	100	
S10ADVI-LBP	18	52	10	43	100	
S10AEVI-LBP	22	59	13	61	100	
S10AFVI-LBP	28	58	10	74	100	
S10AGVI-LBP	35	72	18	110	60	
S10AHVI-LBP	42	88	24	165	30	
S10AJVI-LBP	54	96	22	223	30	



Manicotto passante
Slip Coupling

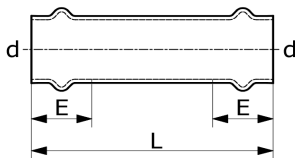

Code	d	L	E	 g	MOQ	€
S11ACVI-LBP	15	74	24	51	100	
S11ADVI-LBP	18	76	25	62	50	
S11AEVI-LBP	22	85	27	85	50	
S11AFVI-LBP	28	90	28	111	50	
S11AGVI-LBP	35	106	31	160	50	
S11AHVI-LBP	42	126	35	233	30	
S11AJVI-LBP	54	141	40	324	20	



Manicotto di riduzione MF
Reducer with plain end

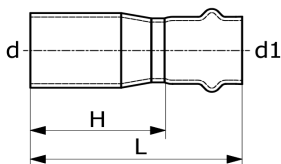

Code	d - d1	L	H	 g	MOQ	€
S12DCVI-LBP	18-15	57	36	38	100	
S12ECVI-LBP	22-15	62	41	46	100	
S12EDVI-LBP	22-18	60	39	48	100	
S12FCVI-LBP	28-15	75	54	65	80	
S12FDVI-LBP	28-18	71	50	65	80	
S12FEVI-LBP	28-22	67	44	68	100	
S12GDVI-LBP	35-18	74	53	80	30	
S12GEVI-LBP	35-22	78	55	90	80	
S12GFVI-LBP	35-28	70	46	89	80	
S12HEVI-LBP	42-22	92	69	118	30	
S12HFVI-LBP	42-28	95	71	132	30	
S12HGVI-LBP	42-35	90	63	136	30	
S12JFVI-LBP	54-28	99	75	165	20	
S12JGVI-LBP	54-35	105	78	188	20	
S12JHVI-LBP	54-42	113	81	215	20	
S12KHVI-LBP	76,1-42	152	120	475	10	
S12KJVI-LBP	76,1-54	144	107	480	10	
S12LJVI-LBP	88,9-54	161	124	590	10	
S12MJVI-LBP	108-54	222	185	940	10	

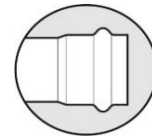

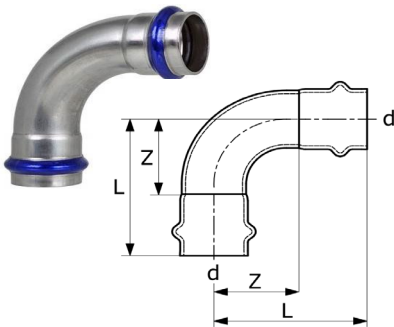

Curva 90°
Bend 90°

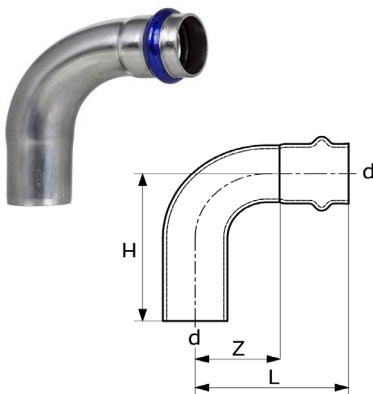

Code	d	L	Z		MOQ	€
S20ACVI-LBP	15	50	29	62	100	
S20ADVI-LBP	18	55	34	75	100	
S20AEVI-LBP	22	62	39	104	100	
S20AFVI-LBP	28	73	49	149	60	
S20ZGVI-LBP	35	73	46	182	60	
S20ZHVI-LBP	42	94	62	283	30	
S20ZJVI-LBP	54	111	74	419	20	

Curva 90° MF
Bend 90° with plain end



Code	d	L	H	Z		MOQ	€
S21ACVI-LBP	15	50	60	29	64	100	
S21ADVI-LBP	18	55	66	34	77	100	
S21AEVI-LBP	22	62	72	39	104	100	
S21AFVI-LBP	28	73	82	49	150	50	
S21ZGVI-LBP	35	73	81	46	183	50	
S21ZHVI-LBP	42	94	102	62	282	20	
S21ZJVI-LBP	54	111	120	74	421	20	

Curva 45°
Bend 45°



Code	d	L	Z		MOQ	€
S22ACVI-LBP	15	35	14	49	100	
S22ADVI-LBP	18	38	17	59	100	
S22AEVI-LBP	22	41	18	79	100	
S22AFVI-LBP	28	48	24	112	50	
S22ZGVI-LBP	35	56	29	160	50	
S22ZHVI-LBP	42	64	32	222	20	
S22ZJVI-LBP	54	72	35	313	20	

Curva 45° MF
Bend 45° with plain end

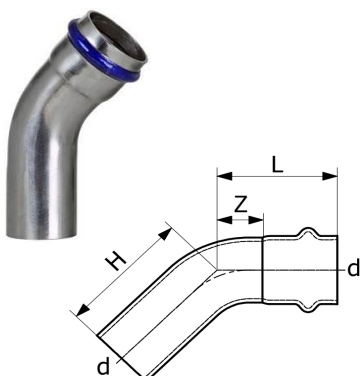

Code	d	L	H	Z		MOQ	€
S23ACVI-LBP	15	35	43	14	50	100	
S23ADVI-LBP	18	38	48	17	61	100	
S23AEVI-LBP	22	41	48	18	78	100	
S23AFVI-LBP	28	48	55	24	112	50	
S23ZGVI-LBP	35	56	67	29	164	50	
S23ZHVI-LBP	42	64	73	32	222	20	
S23ZJVI-LBP	54	72	81	35	387	20	

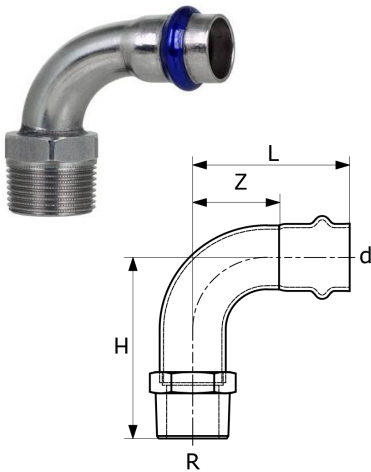
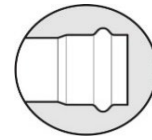

Adattatore 90° - filetto maschio
Bend adaptor 90° with male thread

Code	d - R	L	H	Z	 g	MOQ	€
S83PCVI-LBP	15-R $\frac{1}{2}$	50	58	29	86	20	
S83QDVI-LBP	18-R $\frac{3}{4}$	55	63	34	105	20	
S83PDVI-LBP	18-R $\frac{1}{2}$	55	61	34	93	20	
S83QEVI-LBP	22-R $\frac{3}{4}$	62	69	39	128	20	
S83RFVI-LBP	28-R1	73	81	49	206	20	
S83SGVI-LBP	35-R1 $\frac{1}{4}$	73	94	46	293	15	
S83THVI-LBP	42-R1 $\frac{1}{2}$	94	116	62	396	15	
S83VJVI-LBP	54-R2	111	143	74	683	15	

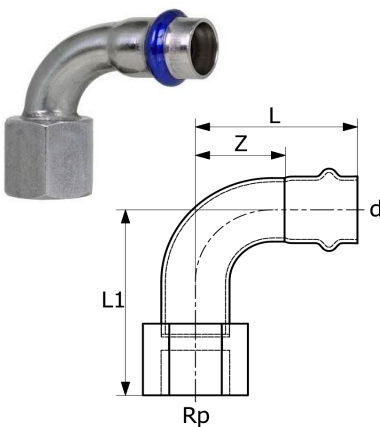

Adattatore 90° - filetto femmina
Bend adaptor 90° with female thread

Code	d - Rp	L	L1	Z	 g	MOQ	€
S82PCVI-LBP	15-Rp $\frac{1}{2}$	50	59	29	88	20	
S82PDVI-LBP	18-Rp $\frac{1}{2}$	55	59	34	94	20	
S82QDVI-LBP	18-Rp $\frac{3}{4}$	55	65	34	122	20	
S82QEVI-LBP	22-Rp $\frac{3}{4}$	62	68	39	137	20	
S82RFVI-LBP	28-Rp1	73	80	49	199	20	

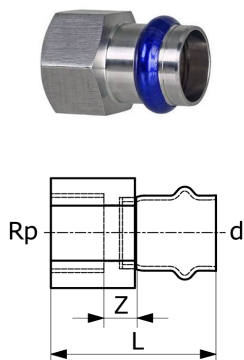

Manicotto misto - filetto femmina
Adaptor with female thread

Code	d - Rp	L	Z	 g	MOQ	€
S80PCVI-LBP	15-Rp $\frac{1}{2}$	47	14	59	100	
S80QCVI-LBP	15-Rp $\frac{3}{4}$	48	14	81	60	
S80PDVI-LBP	18-Rp $\frac{1}{2}$	43	10	68	100	
S80QDVI-LBP	18-Rp $\frac{3}{4}$	46	12	109	100	
S80PEVI-LBP	22-Rp $\frac{1}{2}$	43	8	115	100	
S80QEVI-LBP	22-Rp $\frac{3}{4}$	47	11	113	100	
S80REVI-LBP	22-Rp1	49	10	155	80	
S80QFVI-LBP	28-Rp $\frac{3}{4}$	50	13	177	80	
S80RFVI-LBP	28-Rp1	54	14	152	80	
S80RGVI-LBP	35-Rp1	83	40	155	50	
S80SGVI-LBP	35-Rp1 $\frac{1}{4}$	72	28	203	50	
S80THVI-LBP	42-Rp1 $\frac{1}{2}$	80	31	302	30	
S80VJVI-LBP	54-Rp2	88	29	404	20	

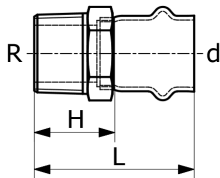
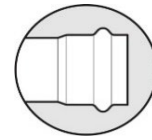

Manicotto misto - filetto maschio
Adaptor with male thread

Code	d - R	L	H		MOQ	€
S81NCVI-LBP	15-R $\frac{3}{8}$	51	30	50	60	
S81PCVI-LBP	15-R $\frac{1}{2}$	49	28	68	100	
S81QCVI-LBP	15-R $\frac{3}{4}$	51	30	78	50	
S81PDVI-LBP	18-R $\frac{1}{2}$	50	29	72	100	
S81QDVI-LBP	18-R $\frac{3}{4}$	52	31	99	50	
S81PEVI-LBP	22-R $\frac{1}{2}$	53	30	113	100	
S81QEVI-LBP	22-R $\frac{3}{4}$	56	33	127	100	
S81REVI-LBP	22-R1	56	33	168	100	
S81QFVI-LBP	28-R $\frac{3}{4}$	55	31	160	80	
S81RFVI-LBP	28-R1	57	33	165	100	
S81RGVI-LBP	35-R1	84	57	163	50	
S81SGVI-LBP	35-R1 $\frac{1}{4}$	71	44	193	50	
S81SHVI-LBP	42-R1 $\frac{1}{4}$	74	42	200	20	
S81THVI-LBP	42-R1 $\frac{1}{2}$	81	49	231	20	
S81VJVI-LBP	54-R2	90	53	411	20	

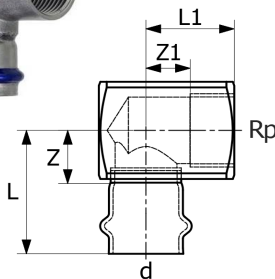

Gomito misto - filetto femmina
Elbow adaptor 90° with female thread

Code	d - Rp	L	L1	Z	Z1		MOQ	€
S30PCVI-LBP	15-Rp $\frac{1}{2}$	54	37	33	25	127	80	
S30PDVI-LBP	18-Rp $\frac{1}{2}$	55	39	34	27	140	60	
S30QEVI-LBP	22-Rp $\frac{3}{4}$	59	46	36	33	225	50	
S30RFVI-LBP	28-Rp1	62	54	38	38	404	50	
S30SGVI-LBP	35-Rp1 $\frac{1}{4}$	73	63	46	46	589	30	

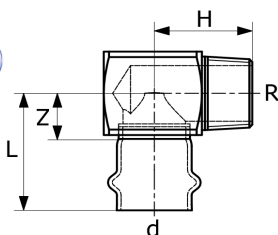

Gomito misto - filetto maschio
Elbow adaptor 90° with male thread

Code	d - R	L	Z	H		MOQ	€
S31PCVI-LBP	15-R $\frac{1}{2}$	54	33	37	107	50	
S31PDVI-LBP	18-R $\frac{1}{2}$	55	34	37	114	50	

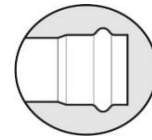

Gomito misto con flangia
90° female elbow adaptor with wall plate

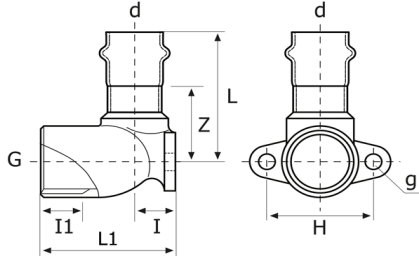

Code	d - G (ISO 228)	L	L1	Z	I	I1	H	g		MOQ	€
S32PCVI-LBP	15-G $\frac{1}{2}$	47	43	26	13	14	34	5	111	80	
S32PDVI-LBP	18-G $\frac{1}{2}$	48	43	27	13	14	34	5	106	60	
S32QEVI-LBP	22-G $\frac{3}{4}$	53	51	30	17	15	40	6	163	60	



Gomito misto con flangia lunga
90° female elbow adaptor with long wall plate

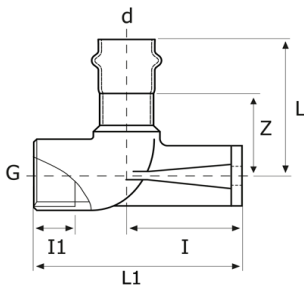

Codice	d - G	L	L1	Z	I	I1		MOQ	€
S39PCVI-LBP	15-G $\frac{1}{2}$	47	75	26	45	14	161	50	
S39PDVI-LBP	18-G $\frac{1}{2}$	47	75	26	45	14	156	50	
S39PEVI-LBP	22-G $\frac{1}{2}$	53	79	30	45	14	194	50	
S39QEVI-LBP	22-G $\frac{3}{4}$	52	79	29	45	15	210	50	



Flangia con bicchiere PN 10/16
Flange with pressing socket PN 10/16

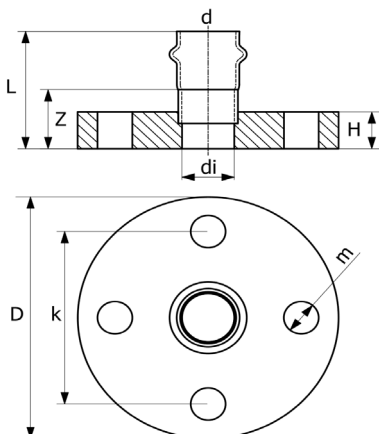

Code	d	D	di	L	H	m	k	Z		MOQ	€
S52ACVI-LBP	15	95	14	56	11	14	65	35	593	20	
S52ADVI-LBP	18	95	17	54	11	14	65	33	588	20	
S52AEVI-LBP	22	105	21	62	12	14	75	39	794	20	
S52AFVI-LBP	28	115	27	66	14	14	85	42	1.102	20	
S52AGVI-LBP	35	140	32	73	15	18	100	46	1.727	20	
S52AHVI-LBP	42	150	39	81	16	18	110	49	2.110	15	
S52AJVI-LBP	54	165	51	109	18	18	125	72	2.861	15	

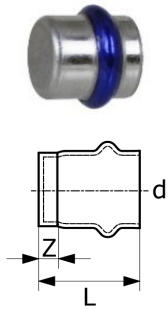
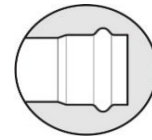

Tappo femmina Cap

Code	d	L	Z		MOQ	€
S50ACVI-LBP	15	38	17	27	100	
S50ADVI-LBP	18	39	18	32	50	
S50AEVI-LBP	22	43	20	46	50	
S50AFVI-LBP	28	46	22	61	50	
S50AGVI-LBP	35	54	27	86	50	
S50AHVI-LBP	42	64	32	125	20	
S50AJVI-LBP	54	71	34	180	20	

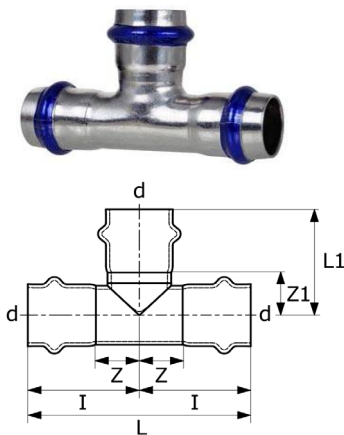

Tee T-piece equal

Code	d	L	L1	Z	Z1	I		MOQ	€
S40ACVI-LBP	15	74	35	16	14	37	70	100	
S40ADVI-LBP	18	76	38	17	17	38	82	100	
S40AEVI-LBP	22	85	41	20	18	43	111	100	
S40AFVI-LBP	28	90	45	21	21	45	143	80	
S40AGVI-LBP	35	106	54	26	27	53	204	50	
S40AHVI-LBP	42	127	66	31	34	63	301	20	
S40AJVI-LBP	54	141	77	34	40	71	419	20	

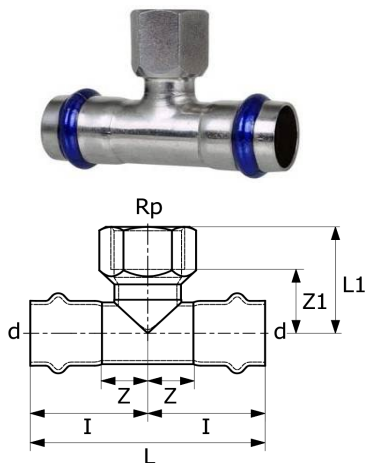

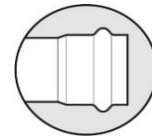

Adattatore tee - filetto femmina T-piece with female thread

Codice	d - Rp - d	L	L1	Z	Z1	I		MOQ	€
S42PCVI-LBP	15-Rp $\frac{1}{2}$ -15	74	37	16	25	37	92	100	
S42PDVI-LBP	18-Rp $\frac{1}{2}$ -18	76	39	17	27	38	100	80	
S42PEVI-LBP	22-Rp $\frac{1}{2}$ -22	85	41	20	29	43	123	100	
S42QEVI-LBP	22-Rp $\frac{3}{4}$ -22	85	41	20	28	43	140	80	
S42PFVI-LBP	28-Rp $\frac{1}{2}$ -28	90	45	21	33	45	149	80	
S42QFVI-LBP	28-Rp $\frac{3}{4}$ -28	90	45	21	32	45	166	50	
S42RFVI-LBP	28-Rp1-28	90	48	21	32	45	190	50	
S42PGVI-LBP	35-Rp $\frac{1}{2}$ -35	106	47	26	35	53	193	50	
S42QGVI-LBP	35-Rp $\frac{3}{4}$ -35	106	47	26	34	53	211	50	
S42PHVI-LBP	42-Rp $\frac{1}{2}$ -42	127	47	31	35	63	276	20	
S42QHVI-LBP	42-Rp $\frac{3}{4}$ -42	127	51	31	38	63	281	20	
S42PJVI-LBP	54-Rp $\frac{1}{2}$ -54	141	54	34	42	71	366	15	
S42QJVI-LBP	54-Rp $\frac{3}{4}$ -54	141	58	34	45	71	370	15	
S42RJVI-LBP	54-Rp1-54	141	62	33	46	70	395	15	

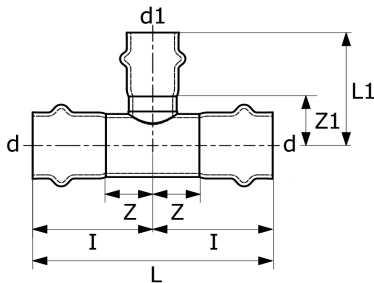

Tee ridotto T-piece reduced



Code	d - d1 - d	L	L1	Z	Z1	I		MOQ	€
S41CDVI-LBP	18-15-18	76	37	17	16	38	79	100	
S41CEVI-LBP	22-15-22	85	39	20	18	43	101	100	
S41DEVI-LBP	22-18-22	85	40	20	19	43	105	100	
S41CFVI-LBP	28-15-28	90	43	21	22	45	127	80	
S41DFVI-LBP	28-18-28	90	43	21	22	45	130	80	
S41EFVI-LBP	28-22-28	90	45	21	22	45	138	80	
S41CGVI-LBP	35-15-35	106	45	26	24	53	172	50	
S41DGVI-LBP	35-18-35	106	45	26	24	53	175	50	
S41EGVI-LBP	35-22-35	106	48	26	25	53	182	50	
S41FGVI-LBP	35-28-35	106	47	26	23	53	188	50	
S41CHVI-LBP	42-15-42	127	49	31	28	63	242	20	
S41DHVI-LBP	42-18-42	127	50	31	29	63	244	20	
S41EHVI-LBP	42-22-42	127	52	31	29	63	252	30	
S41FHVI-LBP	42-28-42	127	52	31	28	63	258	30	
S41GHVI-LBP	42-35-42	127	57	31	30	63	274	30	
S41CJVI-LBP	54-15-54	141	55	34	34	71	331	15	
S41DJVI-LBP	54-18-54	141	57	34	36	71	335	15	
S41EJVI-LBP	54-22-54	141	58	34	35	71	342	20	
S41FJVI-LBP	54-28-54	141	58	34	34	71	348	15	
S41GJVI-LBP	54-35-54	141	65	34	38	71	365	15	
S41HJVI-LBP	54-42-54	141	74	34	42	71	391	15	



Tee ridotto M - V T-piece reduced M-V profile

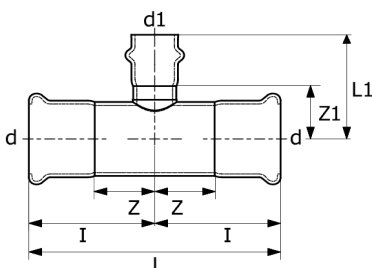

Code	d - d1 - d	L	L1	Z	Z1	I		MOQ
S41GKVM-LBP	76.1-35-76.1	232	76	61	49	116	1.031	20
S41HKVM-LBP	76.1-42-76.1	232	84	61	50	116	1.055	20
S41JKVM-LBP	76.1-54-76.1	232	88	61	51	116	1.078	20
S41GLVM-LBP	88.9-35-88.9	262	84	68	57	131	1.346	20
S41HLVM-LBP	88.9-42-88.9	262	92	68	60	131	1.371	20
S41JLVM-LBP	88.9-54-88.9	262	96	68	59	131	1.394	20
S41GMVM-LBP	108-35-108	312	93	79	66	156	1.939	20
S41HMVM-LBP	108-42-108	312	101	79	69	156	1.963	20
S41JMVM-LBP	108-54-108	312	105	79	68	156	1.985	20

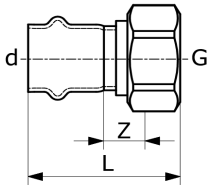
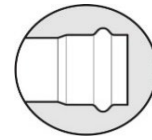

Girella con dado in ottone e guarnizione piatta in EPDM
Adaptor with union nut in brass and EPDM flat seal

Code	d - G (ISO 228)	L	Z	 g	MOQ	€
S60QCVI-LBP	15-G $\frac{3}{4}$	42	14	82	50	
S60QDVI-LBP	18-G $\frac{3}{4}$	42	14	83	50	
S60REVI-LBP	22-G1	45	13	118	50	
S60SFVI-LBP	28-G1 $\frac{1}{4}$	50	16	195	50	
S60TGVV-LBP	35-G1 $\frac{1}{2}$	52	14	290	20	
S60UHVVI-LBP	42-G1 $\frac{3}{4}$	63	19	359	20	
S60WJVVI-LBP	54-G2 $\frac{3}{8}$	70	19	553	20	

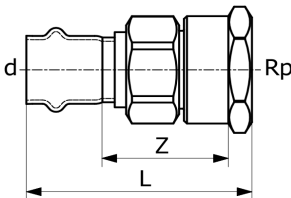

Girella con dado in ottone, raccordo femmina e guarnizione piatta in EPDM
Adaptor union with female thread, brass nut and EPDM flat seal

Code	d - Rp	L	Z	 g	MOQ	€
S62PCVI-LBP	15-Rp $\frac{1}{2}$	65	33	148	15	
S62QCVI-LBP	15-Rp $\frac{3}{4}$	68	35	205	15	
S62PDVI-LBP	18-Rp $\frac{1}{2}$	65	33	149	15	
S62QDVI-LBP	18-Rp $\frac{3}{4}$	68	35	205	15	
S62QEVI-LBP	22-Rp $\frac{3}{4}$	69	34	230	15	
S62REVI-LBP	22-Rp1	73	36	279	15	
S62RFVI-LBP	28-Rp1	77	39	432	15	
S62SGVI-LBP	35-Rp1 $\frac{1}{4}$	81	37	529	15	
S62THVI-LBP	42-Rp1 $\frac{1}{2}$	92	43	636	15	
S62VJVVI-LBP	54-Rp2	104	46	1.163	15	

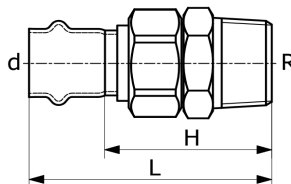

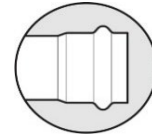

Girella con dado in ottone, raccordo maschio e guarnizione piatta in EPDM
Adaptor union with male thread, brass nut and EPDM flat seal

Code	d - R	L	H	 g	MOQ	€
S64PCVI-LBP	15-R $\frac{1}{2}$	69	48	150	15	
S64QCVI-LBP	15-R $\frac{3}{4}$	72	51	177	15	
S64PDVI-LBP	18-R $\frac{1}{2}$	69	48	150	15	
S64QDVI-LBP	18-R $\frac{3}{4}$	72	51	178	15	
S64PEVI-LBP	22-R $\frac{1}{2}$	73	50	252	15	
S64QEVI-LBP	22-R $\frac{3}{4}$	75	52	228	15	
S64REVI-LBP	22-R1	79	56	291	15	
S64RFVI-LBP	28-R1	84	60	415	15	
S64SGVI-LBP	35-R1 $\frac{1}{4}$	89	62	549	15	
S64THVI-LBP	42-R1 $\frac{1}{2}$	100	68	679	15	
S64VJVVI-LBP	54-R2	113	76	1.141	15	

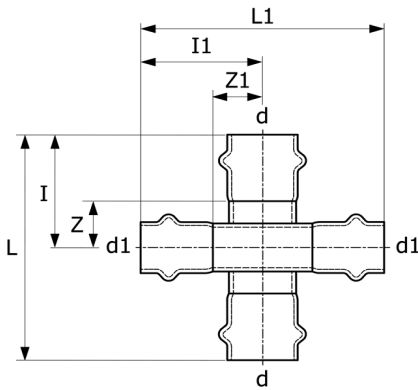

Croce a 90°
Pipe cross 90°



Code	d1 - d2	L	L1	Z	Z1	I	I1		MOQ	€
S45ECVI-LBP	22-15	85	74	20	16	43	37	135	50	



Codolo - filetto maschio
Adaptor with male thread and plain end

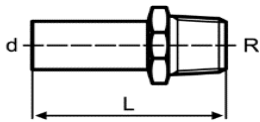

Code	d - R	L		MOQ	€
S87PC	15-R $\frac{1}{2}$	70	60	100	
S87PD	18-R $\frac{1}{2}$	70	63	100	
S87QE	22-R $\frac{3}{4}$	75	78	100	
S87RF	28-R1	75	124	80	
S87SG	35-R1 $\frac{1}{4}$	80	195	80	
S87TH	42-R1 $\frac{1}{2}$	91	233	50	
S87VJ	54-R2	102	419	50	



Codolo - filetto femmina
Adaptor with female thread and plain end

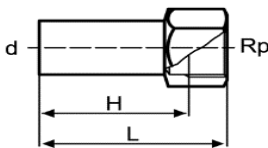

Code	d - Rp	H	L		MOQ	€
S86PC	15-Rp $\frac{1}{2}$	133	148	83	100	
S86PD	18-Rp $\frac{1}{2}$	133	148	90	100	
S86QD	18-Rp $\frac{3}{4}$	131	148	115	100	
S86PE	22-Rp $\frac{1}{2}$	137	152	135	100	
S86QE	22-Rp $\frac{3}{4}$	136	152	137	100	
S86RF	28-Rp1	91	110	147	80	
S86SG	35-Rp1 $\frac{1}{4}$	89	110	242	80	
S86TH	42-Rp1 $\frac{1}{2}$	90	110	335	50	
S86VJ	54-Rp2	94	120	453	50	

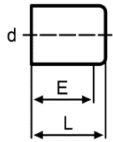
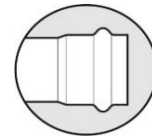

Tappo maschio
Plug

Code	d	E	L		MOQ	€
S51AC	15	33	42	16	100	
S51AD	18	33	40	18	50	
S51AE	22	34	43	30	50	
S51AF	28	36	47	42	50	
S51AG	35	40	49	70	50	
S51AH	42	44	55	96	20	
S51AJ	54	49	62	144	20	

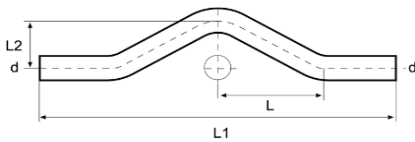

Scavalamento
Pipe bridge

Code	d	L1	L2	L		MOQ	€
S76AC	15	202	38	65	76	15	
S76AD	18	236	43	68	104	15	
S76AE	22	233	40	68	202	10	
S76AF	28	303	64	93	350	10	

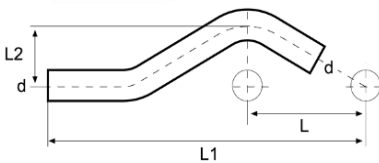

Scavalamento corto
Pipe bridge short

Code	d	L1	L2	L		MOQ	€
S77AC	15	145	37	57	56	10	
S77AD	18	165	38	56	68	10	
S77AE	22	181	40	60	150	10	
S77AF	28	241	55	83	253	10	

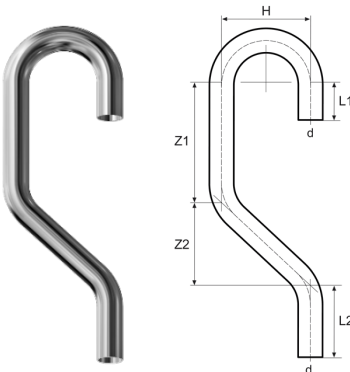

Tubo per aria compressa
Pipe for compressed air

Code	d	L1	L2	Z1	Z2	H		MOQ	€
S69AC	15	30	45	130	65	70	145	40	
S69AD	18	35	66	130	77	76	195	40	
S69AE	22	35	67	127	77	80	292	30	
S69AF	28	40	82	134	97	100	552	30	

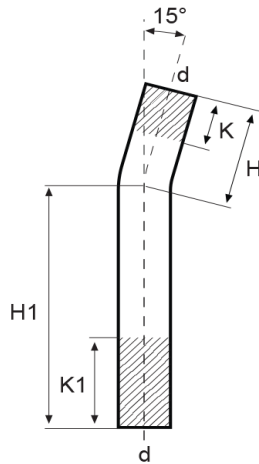
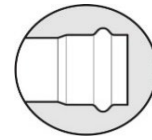

Tubo curvo 15°
Bend 15° with plain ends

Code	d	H1	H	K	K1		MOQ	€
S75AC	15	122	60	21	83	60	30	
S75AD	18	128	55	15	88	74	30	
S75AE	22	124	50	7	81	134	30	
S75AF	28	136	45	7	47	178	20	
S75AG	35	234	62	30	110	378	15	
S75AH	42	276	94	44	144	542	10	
S75AJ	54	337	117	65	165	884	10	
S75AK	76,1	230	226	65	65	1.580	5	
S75AL	88,9	260	240	80	80	1.954	5	
S75AM	108	291	222	95	95	2.516	5	

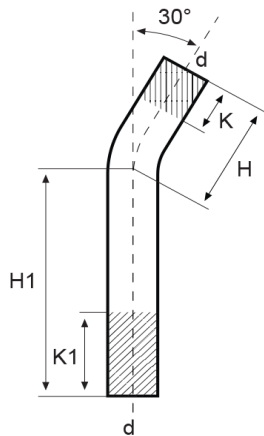

Tubo curvo 30°
Bend 30° with plain ends

Code	d	H1	H	K	K1		MOQ	€
S74AC	15	122	60	21	83	57	30	
S74AD	18	128	55	16	89	74	30	
S74AE	22	124	50	6	80	134	30	
S74AF	28	130	54	7	47	258	20	
S74AG	35	218	80	30	110	376	15	
S74AH	42	274	98	44	144	558	10	
S74AJ	54	324	137	65	165	912	10	
S74AK	76,1	200	202	66	66	1.350	5	
S74AL	88,9	262	264	80	80	2.110	5	
S74AM	108	259	272	95	95	2.622	5	

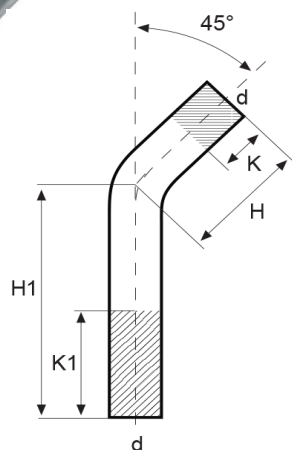

Tubo curvo 45°
Bend 45° with plain ends

Code	d	H1	H	K	K1		MOQ	€
S73AC	15	120	62	19	77	62	30	
S73AD	18	124	58	16	82	73	30	
S73AE	22	120	56	7	71	132	30	
S73AF	28	122	58	2	66	160	20	
S73AG	35	206	94	20	132	375	15	
S73AH	42	262	114	1	149	562	10	
S73AJ	54	321	146	37	212	906	10	
S73AK	76,1	225	225	69	69	1.618	5	
S73AL	88,9	267	267	103	103	2.078	5	
S73AM	108	293	293	66	66	2.988	5	

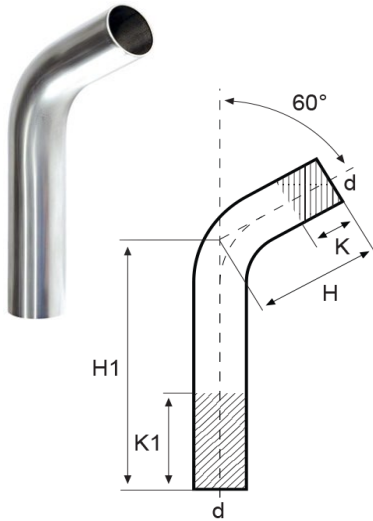
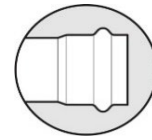

Tubo curvo 60°
Bend 60° with plain ends

Code	d	H1	H	K	K1		MOQ	€
S72AC	15	122	60	21	83	60	30	
S72AD	18	122	62	16	76	70	30	
S72AE	22	118	60	5	63	130	30	
S72AF	28	116	71	7	47	178	20	
S72AG	35	226	101	30	110	406	15	
S72AH	42	251	124	44	145	562	10	
S72AJ	54	308	162	65	165	884	10	
S72AK	76,1	219	223	70	70	1.476	5	
S72AL	88,9	250	257	80	80	1.970	5	
S72AM	108	288	298	95	95	2.844	5	

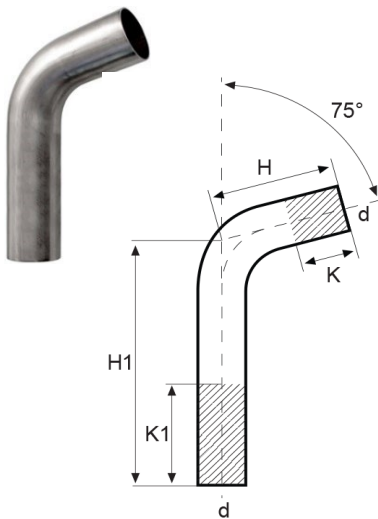

Tubo curvo 75°
Bend 75° with plain ends

Code	d	H1	H	K	K1		MOQ	€
S71AC	15	117	66	22	73	58	30	
S71AD	18	120	65	17	72	70	30	
S71AE	22	118	64	9	63	130	30	
S71AF	28	114	71	7	50	186	20	
S71AG	35	200	110	26	119	378	15	
S71AH	42	251	137	44	158	556	10	
S71AJ	54	305	178	60	187	893	10	
S71AK	76,1	240	240	62	62	1.556	5	
S71AL	88,9	280	280	90	90	2.130	5	
S71AM	108	330	330	45	45	3.360	5	

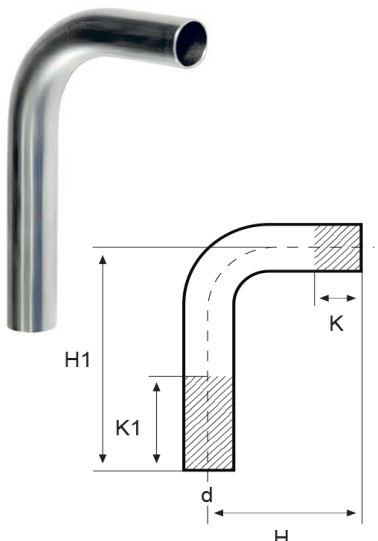

Tubo curvo 90°
Bend 90° with plain ends

Code	d	H1	H	K	K1		MOQ	€
S70AC	15	120	70	22	72	54	40	
S70AD	18	120	70	17	67	72	40	
S70AE	22	120	70	9	59	128	20	
S70AF	28	125	97	7	47	204	20	
S70AG	35	200	120	30	110	362	10	
S70AH	42	250	160	44	144	568	10	
S70AJ	54	305	200	65	165	908	10	
S70AK	76,1	250	250	62	62	1.668	5	
S70AL	88,9	291	291	90	90	2.022	5	
S70AM	108	364	364	45	45	3.200	5	

ACCESSORI 

ACCESSORIES 





O-ring in EPDM nero per acqua potabile (Certificato DVGW W 534)
Seal ring EPDM black for drinkable water (Approved by DVGW W 534)

Code	Ø	E	C		MOQ	€
OR000719	12	12	2,4	0,3	150	
OR000720	15	15	2,6	0,3	150	
OR000721	18	18	2,6	0,4	150	
OR000722	22	22	3,2	0,7	150	
OR000723	28	28	3,1	0,8	150	
OR000724	35	35	3,1	1,0	100	
OR000725	42	42	4,1	2,2	100	
OR000726	54	54	4,1	2,8	100	
OR000727	76,1	77	7	11,5	50	
OR000728	88,9	89	8,1	17,5	50	
OR000729	108	109	10	33,8	50	



POLYGONAL

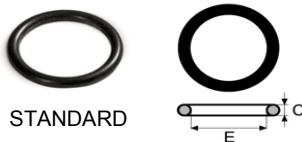
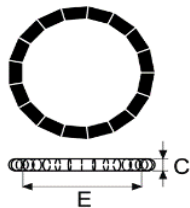

STANDARD

O-ring in EPDM nero per acqua potabile (Certificato LBP DVGW W 534)
Seal ring EPDM black for drinkable water (LBP Approved by DVGW W534)

Code	Ø	E	C		MOQ	€
008875	12	12	2,4	0,3	150	
008876	15	15	2,6	0,3	150	
008877	18	18	2,6	0,4	150	
008878	22	22	3,2	0,7	150	
008879	28	28	3,1	0,8	150	
008880	35	35	3,1	1,0	100	
008881	42	42	4,1	2,2	100	
008882	54	54	4,1	2,8	100	
OR000727	76,1	77	7	11,5	50	
OR000728	88,9	89	8,1	17,5	50	
OR000729	108	109	10	33,8	50	

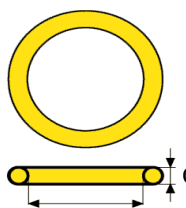

O-ring in HNBR giallo per gas (standard per acciaio Inox Gas DVGW G 5614)
Seal ring HNBR yellow for gas (standard for stainless steel Gas DVGW G 5614)

Code	Ø	E	C		MOQ	€
002579	15	15	2,6	0,3	150	
002580	18	18	2,6	0,4	150	
002581	22	22	3,2	0,7	150	
002582	28	28	3,1	0,8	150	
002583	35	35	3,1	1,0	100	
002584	42	42	4,1	2,2	100	
002585	54	54	4,1	2,8	100	
003266	76,1	77	7	11,5	50	
003267	88,9	89	8,1	17,5	50	
003268	108	109	10	33,8	50	

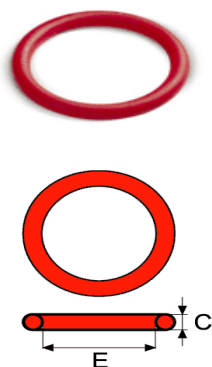

O-ring in FPM rosso per olii e idrocarburi fino a 180°
Seal ring FPM red for oil and hydrocarbon until 180°

Code	Ø	E	C		MOQ	€
007496	12	12	2,4	0,3	100	
007243	15	15	2,6	0,3	100	
007244	18	18	2,6	0,4	100	
007245	22	22	3,2	0,7	100	
007246	28	28	3,1	0,8	100	
007247	35	35	3,1	1,0	50	
007248	42	42	4,1	2,2	50	
007249	54	54	4,1	2,8	50	
007250	76,1	77	7	11,5	20	
007251	88,9	89	8,1	17,5	20	
007252	108	109	10	33,8	20	

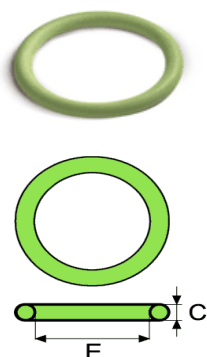

O-ring in FPM verde per impianti solari, olii e idrocarburi fino a 180°
Seal ring FPM green for solar systems, oil and hydrocarbon until 180°

Code	Ø	E	C		MOQ	€
002485	12	12	2,4	0,3	100	
002849	15	15	2,6	0,3	100	
002850	18	18	2,6	0,4	100	
002851	22	22	3,2	0,7	100	
002852	28	28	3,1	0,8	100	
002853	35	35	3,1	1,0	50	
002854	42	42	4,1	2,2	50	
002855	54	54	4,1	2,8	50	
002983	76,1	77	7	11,5	20	
002984	88,9	89	8,1	17,5	20	
002985	108	109	10	33,8	20	



Guarnizione piatta in EPDM nera per acqua potabile
Flat gasket EPDM black for drinkable water

Code	Ø	A	B	C		MOQ	€
002409	15	15	23	2	0,5	100	
002409	18	15	23	2	0,5	100	
002410	22	22	30	2	0,7	100	
002411	28	27	39	2	1,4	100	
002412	35	32	45	2	1,3	50	
002413	42	40	51	2	1,7	50	
002414	54	51	66	3	4,0	50	

Big Size disponibili su richiesta. Contattare il nostro Ufficio Commerciale.
Big Sizes available upon request, please contact our Sales Dept.

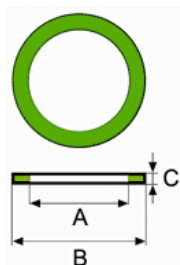

Guarnizione piatta in FPM verde per impianti solari, olii e idrocarburi fino a 180° Flat gasket FPM green for solar systems, oil and hydrocarbon until 180°

Code	Ø	A	B	C		MOQ	€
004992	15	15	23	2	0,5	100	
004992	18	15	23	2	0,5	100	
004993	22	22	30	2	0,7	100	
004994	28	27	39	2	1,4	100	
004995	35	32	45	2	1,3	50	
004996	42	40	51	2	1,7	50	
004997	54	51	66	3	4,0	30	

Big Size disponibili su richiesta. Contattare il nostro Ufficio Commerciale.
Big Sizes available upon request, please contact our Sales Dept.

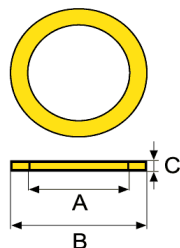

Guarnizione piatta in HNBR per gas Flat gasket HNBR yellow for gas

Code	Ø	A	B	C		MOQ	€
003237	15	15	23	2	0,5	100	
003237	18	15	23	2	0,5	100	
003238	22	22	30	2	0,7	100	
003239	28	27	39	2	1,4	100	
003240	35	32	45	2	1,3	50	
003241	42	40	51	2	1,7	50	
003242	54	51	66	3	4,0	50	

Big Size disponibili su richiesta. Contattare il nostro Ufficio Commerciale.
Big Sizes available upon request, please contact our Sales Dept.



isiprex

Stainless Steel · Tubes · Fittings

+39 339 28 23 799

Via Cercè 10, 23842
Bosisio Parini (LC)

info@isiprex.com
P.IVA 03820370132